

**COPPER RING TONGUE TERMINAL ENDS FOR
SOLDERLESS CRIMPING TO COPPER /
ALUMINUM CONDUCTORS.**

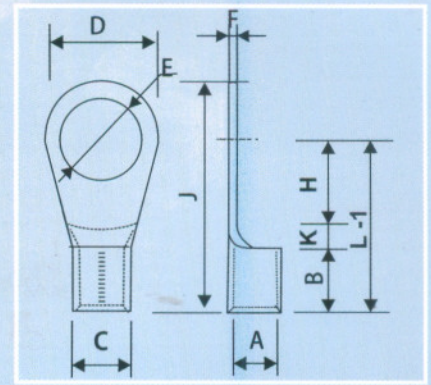

- Copper IS - 1897
- Electro Tinned finish

Item No.	AREA mm ²	E	A	C	D	F	B	K	H	L-1	J	KAYCEE CAT. No.
1	1.5	2.2	1.6	3.2	6	0.8	5	2	4.0	11.0	14.0	KC 7103
2	1.5	2.6	1.6	3.2	6.0	0.8	5	2	4.0	11.0	14.0	KC 7000
3	1.5	3.2	1.6	3.2	6.0	0.8	5	2	4.0	11.0	14.0	KC 7001
4	1.5	3.2	1.6	3.2	6.8	0.8	5	1	3.6	9.6	13.0	KC 7153
5	1.5	3.2	1.6	3.2	8	0.8	5	2	5.0	12.0	16.0	KC 7104
6	1.5	3.7	1.6	3.2	6.8	0.8	5	1	3.6	9.6	13.0	KC 7048
7	1.5	3.7	1.6	3.2	6.0	0.8	5	2	4.0	11.0	14.0	KC 7002
8	1.5	4.2	1.6	3.2	6.8	0.8	5	1	3.6	9.6	13.0	KC 7049
9	1.5	4.2	1.6	3.2	6.0	0.8	5	2	4.0	11.0	14.0	KC 7003
10	1.5	4.2	1.6	3.2	7.0	0.8	5	1	5.0	11.0	14.5	KC 7154
11	1.5	4.2	1.6	3.2	8.0	0.8	5	2	5.0	12.0	16.0	KC 7004
12	1.5	4.2	1.6	3.2	10	0.8	5	2	6.0	13.0	18.0	KC 7105
13	1.5	5.2	1.6	3.2	8.0	0.8	5	2	5.0	12.0	16.0	KC 7005
14	1.5	5.2	1.6	3.2	10.0	0.8	5	2	6.0	13.0	18.0	KC 7006
15	1.5	6.4	1.6	3.2	10.0	0.8	5	2	6.0	13.0	18.0	KC 7007
16	1.5	6.4	1.6	3.2	12.0	0.8	5	1	6.0	12.0	18.0	KC 7106
17	2.5	3.2	2.3	3.9	6.5	0.8	5	1	3.5	9.5	12.7	KC 7107
18	2.5	3.7	2.3	3.9	6.5	0.8	5	1	3.5	9.5	12.7	KC 7008
19	2.5	3.7	2.3	3.9	8.0	0.8	5	2	5.0	12.0	16.0	KC 7108
20	2.5	4.2	2.3	3.9	8.0	0.8	5	2	5.0	12.0	16.0	KC 7009
21	2.5	5.2	2.3	3.9	8.0	0.8	5	2	5.0	12.0	16.0	KC 7010
22	2.5	5.2	2.3	3.9	10.0	0.8	5	1	7.0	13.0	18.0	KC 7109
23	2.5	5.2	2.3	3.9	12.0	0.8	5	2	9.0	16.0	22.0	KC 7110
24	2.5	6.4	2.3	3.9	10.0	0.8	5	1	7.0	13.0	18.0	KC 7011
25	2.5	6.4	2.3	3.9	12.0	0.8	5	2	9.0	16.0	22.0	KC 7012
26	2.5	6.4	2.3	3.9	16	0.8	5	2	10.0	17.0	25.0	KC 7111
27	2.5	8.2	2.3	3.9	12.0	0.8	5	2	9.0	16.0	22.0	KC 7013
28	2.5	8.2	2.3	3.9	16.0	0.8	5	2	10.0	17.0	25.0	KC 7014
29	2.5	10.2	2.3	3.9	18.0	0.8	5	1	14.0	20.0	29.0	KC 7151
30	2.5	10.2	2.3	3.9	16	0.8	5	2	10.0	17.0	25.0	KC 7015
31	2.5	12.7	2.3	3.9	18	0.8	5	1	14.0	20.0	29.0	KC 7047
32	4-6	4.2	3.5	5.5	8.0	1.0	6	2	5.0	13.0	17.0	KC 7155
33	4-6	4.2	3.5	5.5	10	1.0	6	3	5.0	14.0	19.0	KC 7112
34	4-6	5.2	3.5	5.5	8.0	1.0	6	2	5.0	13.0	17.0	KC 7050
35	4-6	5.2	3.5	5.5	8.0	1.0	6	3	9.8	18.8	22.8	KC 7157
36	4-6	5.2	3.5	5.5	10.0	1.0	6	3	5.0	14.0	19.0	KC 7016
37	4-6	5.2	3.5	5.5	12	1.0	6	2	6.0	14.0	20.0	KC 7113
38	4-6	5.2	3.5	5.5	12	1.0	6	3	7.0	16.0	22.0	KC 7114
39	4-6	6.4	3.5	5.5	12	1.0	6	2	6	14	20	KC 7017
40	4-6	6.4	3.5	5.5	12	1.0	6	3	7	16	22	KC 7019
41	4-6	6.4	3.5	5.5	14	1.0	6	2	10.5	18.5	25.5	KC 7115
42	4-6	8.2	3.5	5.5	12	1.0	6	2	6	14	20	KC 7018
43	4-6	8.2	3.5	5.5	18	1.0	6	3	12.0	21.0	30.0	KC 7117
44	4-6	8.2	3.5	5.5	14	1.0	6	2	10.5	18.5	25.5	KC 7020
45	4-6	8.2	3.5	5.5	16	1.0	6	3	13	22	30	KC 7116
46	4-6	9.7	3.5	5.5	14	1.0	6	2	10.5	18.5	25.5	KC 7021

Item No.	AREA mm ²	E	A	C	D	F	B	K	H	L-1	J	KAYCEE CAT. No.
47	4-6	10.2	3.5	5.5	18	1.0	6	3	12	21	30	KC 7023
48	4-6	10.2	3.5	5.5	16	1.0	6	3	13.0	22.0	30.0	KC 7022
49	4-6	12.7	3.5	5.5	18	1.0	6	3	12	21	30	KC 7024
50	10	4.2	4.3	6.3	10	1.0	8	3	4	15	20	KC 7119
51	10	4.2	4.3	6.3	10	1.0	8	2	7.0	17.0	22.0	KC 7118
52	10	5.2	4.3	6.3	10	1.0	8	2	7	17	22	KC 7025
53	10	5.2	4.3	6.3	10	1.0	8	3	4	15	20	KC 7026
54	10	6.4	4.3	6.3	12	1.0	8	2	7	17	23	KC 7120
55	10	8.2	4.3	6.3	16	1.0	8	4	7	19	27	KC 7121
56	10	8.2	4.3	6.3	18	1.0	8	4	9.0	21.0	30.0	KC 7122
57	10	10.2	4.3	6.3	22	1.0	8	5	10	23	34	KC 7123
58	10	10.2	4.3	6.3	18	1.0	8	4	9.0	21.0	30.0	KC 7027
59	10	12.7	4.3	6.3	22	1.0	8	5	10	23	34	KC 7028
60	16	5.2	5.6	8.0	10	1.2	10	3	6	19	24	KC 7124
61	16	5.2	5.6	8.0	12	1.2	10	4	6	20	26	KC 7125
62	16	6.4	5.6	8.0	12	1.2	10	4	6	20	26	KC 7029
63	16	6.4	5.6	8.0	16	1.2	10	4	8	22	30	KC 7126
64	16	8.2	5.6	8.0	16	1.2	10	4	8	22	30	KC 7030
65	16	8.2	5.6	8.0	18	1.2	10	4	10	24	33	KC 7127
66	16	9.7	5.6	8.0	16	1.2	10	4	8	22	30	KC 7031
67	16	10.2	5.6	8.0	22	1.2	10	6	8	24	35	KC 7128
68	16	10.2	5.6	8.0	18	1.2	10	4	10	24	33	KC 7032
69	16	12.7	5.6	8.0	22	1.2	10	6	8	24	35	KC 7033
70	25	6.4	7.5	11.1	16	1.8	11	4	10	25	33	KC 7130
71	25	6.4	7.5	11.1	12	1.8	11	4	10	25	31	KC 7156
72	25	6.4	7.5	11.1	16	1.8	11	5	6	22	30	KC 7129
73	25	8.2	7.5	11.1	16	1.8	11	5	6	22	30	KC 7034
74	25	8.2	7.5	11.1	12	1.8	11	4	10	25	31	KC 7051
75	25	8.2	7.5	11.1	16	1.8	11	4	10	25	33	KC 7036
76	25	10.2	7.5	11.1	18	1.8	11	5	9	25	34	KC 7131
77	25	10.2	7.5	11.1	16	1.8	11	5	6	22	30	KC 7035
78	25	10.2	7.5	11.1	22	1.8	11	6	14	31	42	KC 7132
79	25	12.7	7.5	11.1	22	1.8	11	6	14	31	42	KC 7037
80	35	6.4	9.0	12.6	16	1.8	12	5	6	23	31	KC 7133
81	35	8.2	9.0	12.6	16	1.8	12	5	6	23	31	KC 7038
82	35	8.2	9.0	12.6	18	1.8	12	5	10	27	36	KC 7134
83	35	10.2	9.0	12.6	18	1.8	12	5	10	27	36	KC 7039
84	35	10.2	9.0	12.6	22	1.8	12	4	15	31	42	KC 7135
85	35	12.7	9.0	12.6	22	1.8	12	4	15	31	42	KC 7040
86	50	8.2	10.5	14.1	18	1.8	16	6	12	34	43	KC 7136
87	50	10.2	10.5	14.1	22	1.8	16	7	9	32	43	KC 7137
88	50	10.2	10.5	14.1	18	1.8	16	6	12	34	43	KC 7041
89	50	10.2	10.5	14.1	24	1.8	16	6	14	36	48	KC 7138
90	50	12.7	10.5	14.1	24	1.8	16	6	14	36	48	KC 7042
91	50	16.2	10.5	14.1	32	1.8	16	7	15	38	54	KC 7139
92	70	10.2	12.0	16.0	22	2.0	18	7	11	36	47	KC 7140
93	70	12.7	12.0	16.0	24	2.0	18	8	10	36	48	KC 7141
94	70	12.7	12.0	16.0	22	2.0	18	7	11	36	47	KC 7043
95	70	16.2	12.0	16.0	28	2.0	18	6	16	40	54	KC 7142
96	95	10.2	13.5	18.1	24	2.3	20	6	12	38	50	KC 7144
97	95	10.2	13.5	18.1	22	2.3	20	5	10	35	46	KC 7143
98	95	12.7	13.5	18.1	24	2.3	20	6	12	38	50	KC 7044
99	95	16.2	13.5	18.1	28	2.3	20	7	17	44	58	KC 7145
100	120	12.7	15.0	20.2	26	2.6	22	10	7	39	52	KC 7146
101	120	16.2	15.0	20.2	32	2.6	22	7	19	48	64	KC 7147
102	120	20.3	15.0	20.2	40	2.6	22	10	20	52	72	KC 7148
103	150	12.7	16.5	23.7	34	3.6	24	9	16	49	66	KC 7149
104	150	16.2	16.5	23.7	34	3.6	24	9	16	49	66	KC 7045
105	150	16.2	16.5	23.7	40	3.6	24	10	20	54	74	KC 7150
106	150	20.3	16.5	23.7	40	3.6	24	10	20	54	74	KC 7046

**COPPER TUBULAR END SEALING FERRULES
FOR SOLDERLESS CRIMPING TO COPPER OR
ALLUMINIUM CONDUCTORS**

- Copper BS - 1977
- Electro Tinned finish

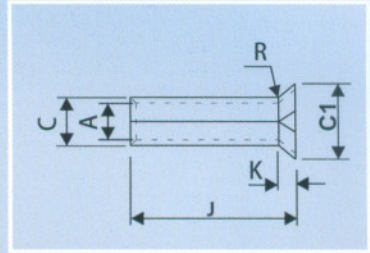

Item No.	AREA mm ²	A	C	C-1 +0 -2	K (Max)	R (Min)	J ±0.4	KAYCEE CAT. No
107	0.5	1.0-1.1	1.4-1.5	2.1	0.7	0.8	6	KCH-508
108	0.75	1.4-1.5	1.8-1.9	2.5	0.7	0.8	6	KCH-509
109	1.0	1.6-1.7	2.0-2.1	2.7	0.7	0.8	6	KCH-510
110	1.0	1.6-1.7	2.0-2.1	2.7	0.7	0.8	10	KCH-511
111	1.5	1.8-1.9	2.2-2.3	2.9	1.0	1.2	7	KCH-512
112	1.5	1.8-1.9	2.2-2.3	2.9	1.0	1.2	10	KCH-513
113	2.5	2.3-2.4	2.7-2.8	3.5	1.0	1.2	7	KCH-514
114	2.5	2.3-2.4	2.7-2.8	3.5	1.0	1.2	12	KCH-515
115	4	2.8-2.9	3.2-3.3	4.0	1.0	1.2	9	KCH-516
116	4	2.8-2.9	3.2-3.3	4.0	1.0	1.2	12	KCH-517
117	6	3.7-3.8	4.1-4.2	4.8	1.0	1.2	10	KCH-518
118	6	3.7-3.8	4.1-4.2	4.8	1.0	1.2	12	KCH-519
119	6	3.7-3.8	4.1-4.2	4.8	1.0	1.2	15	KCH-520
120	10	4.6-4.7	5.0-5.1	5.8	1.2	1.2	12	KCH-521
121	10	4.6-4.7	5.0-5.1	5.8	1.2	1.2	15	KCH-522
122	10	4.6-4.7	5.0-5.1	5.8	1.2	1.2	18	KCH-523
123	16	5.9-6.0	6.3-6.4	7.5	1.5	1.6	12	KCH-524
124	16	5.9-6.0	6.3-6.4	7.5	1.5	1.6	15	KCH-525
125	16	5.9-6.0	6.3-6.4	7.5	1.5	1.6	18	KCH-526

**OPEN-CLOSE TYPE SOLDERING CABLE SOCKETS
FOR ALUMINIUM CONDUCTORS.**

- Copper IS - 1897
- Electro Tinned finish

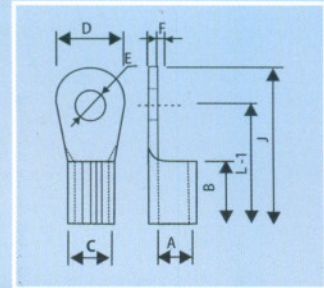

Item No.	AREA mm ²	CABLE SIZE	E	A	C	D	F	B	L-1	J	KAYCEE CAT. No.
126	1.5	1/1.4	4.2	1.6	3.2	7	0.8	5	11.5	15.0	KCOC-371
127	1.5	48/0.2	3.5	2.1	3.7	7	0.8	5	8.0	12.5	KCOC-345
128	2.5	3/1.06	5.2	2.3	3.9	9	0.8	6	13.5	18.0	KCOC-372
129	2.5	80/0.2	5.1	2.6	4.2	9	0.8	5	7.0	16.5	KCOC-344
130	4	7/0.85	5.2	2.8	4.8	9	1.0	6	23.0	20.0	KCOC-373
131	6	7/1.06	6.5	3.6	5.6	12	1.0	7	18.0	24.0	KCOC-374
132	10	7/1.4	6.5	4.4	6.4	12	1.0	9	21.0	27.0	KCOC-375
133	16	7/1.7	8.2	5.4	7.8	15	1.2	11	30.5	32.0	KCOC-376
134	25	7/2.24	8.2	7.0	10.2	15	1.6	14	28.5	36.0	KCOC-377
135	35	7/2.5	8.2	8.0	11.2	18	1.6	15	32.0	41.0	KCOC-378
136	50	19/1.8	10.2	9.5	13.1	24	1.8	18	38.0	50.0	KCOC-379
137	70	19/2.24	10.2	11.8	15.8	28	2.0	23	44.0	58.0	KCOC-380
138	95	19/2.5	12.7	13.5	18.7	32	2.6	25	50.0	66.0	KCOC-381
139	120	37/2.06	12.7	15.5	21.1	34	2.8	29	56.0	73.0	KCOC-382
140	150	37/2.24	12.7	16.5	22.9	38	3.2	30	60.0	79.0	KCOC-383
141	185	37/2.5	16.2	18.5	25.7	42	3.6	35	66.0	87.0	KCOC-384
142	225	37/2.8	16.2	21.1	28.2	44	3.6	40	70.0	92.0	KCOC-385
143	240	61/2.24	16.2	22.5	30.5	48	4.0	42	76.0	100.0	KCOC-386
144	300	61/2.5	20.3	25.0	34.0	54	4.5	45	83.0	110.0	KCOC-387
145	400	61/3.0	20.3	29.5	39.5	62	5.0	54	94.0	125.0	KCOC-388
146	500	91/2.65	20.3	32.0	42.8	62	5.4	58	106.0	137.0	KCOC-389
147	625	91/3.0	20.3	36.0	46.8	70	5.4	65	113.0	148.0	KCOC-390

**COPPER TUBULAR TERMINAL ENDS
FOR SOLDERLESS CRIMPING
TO ALUMINIUM CONDUCTORS**

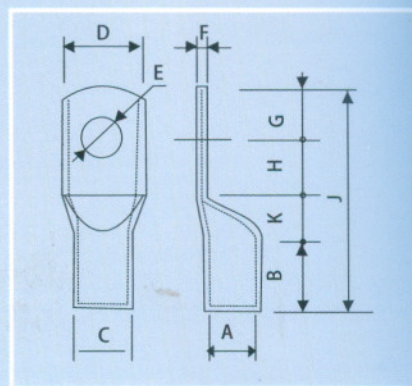

- Copper BS - 1977
- Electro Tinned finish

Item No.	AREA mm ²	CABLE SIZE	E	A	C	D	F	B	K	H	G	J	KAYCEE CAT. No.
148	2.5	1/1.8	5.2	2.0	3.7	9	1.0	7	3	5	5	20	KCUS-05
149	4	1/2.8	6.5	3.1	4.8	11	1.0	7	3	6	6	22	KCUS-06
150	6	1/3.55	6.5	3.8	5.5	11	1.0	9	3	6	6	24	KCUS-07
151	10	7/1.4	6.5	4.4	6.2	11	1.3	9	3	6	6	24	KCUS-08
152	16	7/1.7	6.5	5.3	7.1	11	1.6	12	4	8	6	30	KCUS-09
153	25	7/2.24	6.5	7.0	9.0	13	2.0	12	5	12	8	37	KCUS-10
154	35	7/2.5	6.5	8.0	10.0	15	2.0	12	5	12	8	37	KCUS-11
155	35	7/2.5	8.2	8.0	10.0	15	2.0	12	5	12	8	37	KCUS-12
156	50	19/1.8	6.5	9.2	11.2	16	2.0	16	8	12	9	45	KCUS-13
157	50	19/1.8	8.2	9.2	11.2	16	2.0	16	8	12	9	45	KCUS-14
158	50	19/1.8	10.2	9.2	11.2	16	2.0	16	8	12	9	45	KCUS-15
159	70	19/2.24	8.2	11.5	13.8	20	2.3	18	10	15	13	56	KCUS-16
160	70	19/2.24	10.2	11.5	13.8	20	2.3	18	10	15	13	56	KCUS-17
161	70	19/2.24	12.7	11.5	13.8	20	2.3	18	10	15	13	56	KCUS-18
162	95	19/2.5	10.2	12.8	15.6	23	2.8	20	10	15	13	58	KCUS-19
163	95	19/2.5	12.7	12.8	15.6	23	2.8	20	10	15	13	58	KCUS-20
164	120	37/2.06	10.2	14.8	17.8	26	3.0	22	10	16	14	62	KCUS-21
165	120	37/2.06	12.7	14.8	17.8	26	3.0	22	10	16	14	62	KCUS-22
166	120	37/2.06	16.2	14.8	17.8	26	3.0	22	10	16	14	62	KCUS-23
167	150	37/2.24	10.2	16.0	19.6	28	3.6	26	11	18	15	70	KCUS-24
168	150	37/2.24	12.7	16.0	19.6	28	3.6	26	11	18	15	70	KCUS-25
169	150	37/2.24	16.2	16.0	19.6	28	3.6	26	11	18	15	70	KCUS-26
170	185	37/2.5	12.7	18.0	22.0	32	4.0	28	13	21	21	83	KCUS-27
171	185	37/2.5	16.2	18.0	22.0	32	4.0	28	13	21	21	83	KCUS-28
172	225	37/2.8	16.2	20.0	24.0	35	4.0	32	15	24	24	95	KCUS-231
173	240	61/2.24	16.2	22.0	26.0	38	4.0	34	15	24	24	97	KCUS-29
174	240	61/2.24	20.3	22.0	26.0	38	4.0	34	15	24	24	97	KCUS-30
175	300	61/2.5	16.2	24.0	28.7	42	4.7	36	16	25	25	103	KCUS-31
176	300	61/2.5	20.3	24.0	28.7	42	4.7	36	16	25	25	103	KCUS-32
177	400	61/3.0	20.3	28.0	33.2	49	5.2	44	18	27	27	116	KCUS-33
178	500	91/2.65	20.3	30.0	36.0	53	6.0	48	18	27	27	120	KCUS-34
179	630	91/3.0	20.3	35.0	41.5	61	6.5	53	20	33	31	137	KCUS-35
180	800	91/3.35	-	39.0	46.3	67	7.3	68	25	38	37	165	KCUS-062
181	1000	91/3.75	-	43.0	53.8	76	10.8	90	30	45	45	210	KCUS-076

SOLDERING TYPE COPPER TUBULAR SOCKETS SUITABLE FOR ALUMINIUM CONDUCTORS.

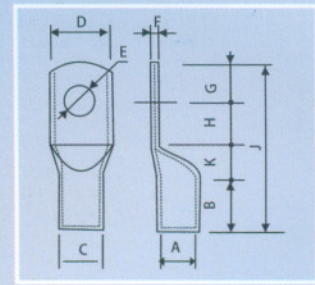

- Copper BS - 1977
- Electro Tinned finish

Item No.	AREA mm ²	CABLE SIZE	E	A	C	D	F	B	K	H	G	J	KAYCEE CAT. No.
182	15	7/1.06	3.2	3.9	4.8	7	0.9	7	2	6	4	19	KCEW-201
183	30	7/1.4	5.1	5.2	6.3	9	1.1	9	3	6	5	23	KCEW-202
184	60	7/2.24	6.4	8.1	9.5	14	1.4	14	4	9	9	36	KCEW-203
185	100	19/1.8	9.5	10.9	12.7	19	1.8	19	8	11	11	49	KCEW-204
186	150	19/2.24	9.5	13.9	15.9	24	2.0	23	8	13	13	57	KCEW-205
187	200	19/2.5	12.7	16.6	19.0	28	2.4	27	11	14	14	66	KCEW-206
188	300	37/2.24	12.7	19.0	22.2	33	3.2	28	13	20	19	80	KCEW-207
189	400	37/2.5	15.9	22.2	25.4	38	3.2	32	15	21	21	89	KCEW-208
190	500	61/2.24	19.0	25.4	28.6	43	3.2	38	17	25	25	105	KCEW-209
191	600	61/2.5	19.0	27.8	31.8	47	4.0	44	17	27	27	115	KCEW-210
192	800	61/3.0	23.8	31.7	38.1	56	6.4	47	18	28	28	121	KCEW-211
193	1000	91/3.0	23.8	38.1	44.5	66	6.4	56	20	42	34	152	KCEW-212
194	1000	91/3.75	----	50.0	57.3	85	7.3	62	20	46	36	164	KCEW-295

COPPER RING TONGUE FORK TERMINAL ENDS ("U" CUT) FOR SOLDERLESS CRIMPING TO COPPER OR ALUMINIUM CONDUCTORS.

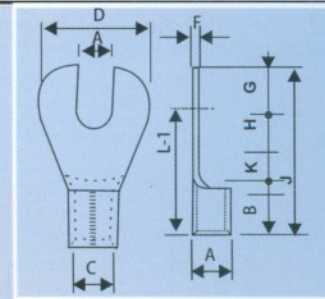

- Copper IS - 1897
- Electro Tinned finish

Item No.	AREA mm ²	E	A	C	D	F	B	K	H	G	L-1	J	KAYCEE CAT. No.
195	1.5	3.1	1.6	3.2	6.0	0.8	5	2	4.0	3.0	11.0	14.0	KC7235
196	1.5	4.1	1.6	3.2	8.0	0.8	5	2	5.0	4.0	12.0	16.0	KC7236
197	1.5	4.1	1.6	3.2	7.0	0.8	5	1	5.0	3.5	11.0	14.0	KC7237
198	1.5	5.1	1.6	3.2	10.0	0.8	5	2	6.0	5.0	13.0	18.0	KC7238
199	1.5	3.6	1.6	3.2	6.0	0.8	5	2	4.0	3.0	11.0	14.0	KC7240
200	1.5	3.1	1.6	3.2	6.8	0.8	5	---	4.6	3.4	9.6	13.0	KC7241
201	1.5	3.6	1.6	3.2	6.8	0.8	5	---	4.6	3.4	9.6	13.0	KC7244
202	1.5	6.1	1.6	3.2	10.0	0.8	5	2	6.0	5.0	13.0	18.0	KC7861
203	2.5	3.1	2.3	3.9	6.5	0.8	5	1	3.5	3.2	9.5	12.7	KC7862
204	2.5	3.6	2.3	3.9	6.5	0.8	5	1	3.5	3.2	9.5	12.7	KC7863
205	2.5	6.1	2.3	3.9	10.0	0.8	5	1	7.0	5.0	13.0	18.0	KC7864
206	2.5	4.1	2.3	3.9	8.0	0.8	5	2	5.0	4.0	12.0	16.0	KC7239
207	2.5	5.1	2.3	3.9	10.0	0.8	5	1	7.0	5.0	13.0	18.0	KC7242
208	4-6	4.1	3.5	5.5	8.0	1.0	6	2	5.0	4.0	13.0	17.0	KC7243
209	4-6	4.1	3.5	5.5	10.0	1.0	6	3	5.0	5.0	14.0	19.0	KC7245
210	4-6	5.1	3.5	5.5	10.0	1.0	6	3	5.0	5.0	14.0	19.0	KC7246
211	4-6	5.1	3.5	5.5	10.0	1.0	6	3	7.0	6.0	16.0	22.0	KC7247
212	4-6	6.1	3.5	5.5	12.0	1.0	6	3	7.0	6.0	16.0	22.0	KC7248
213	10	4.1	4.3	6.3	10.0	1.0	8	2	7.0	5.0	17.0	22.0	KC7865
214	10	5.1	4.3	6.3	10.0	1.0	8	2	7.0	5.0	17.0	22.0	KC7866
215	10	6.1	4.3	6.3	12.0	1.0	8	2	7.0	6.0	17.0	23.0	KC7867
216	10	8.1	4.3	6.3	16.0	1.0	8	4	7.0	8.0	19.0	27.0	KC7868
217	16	5.1	5.6	8.0	10.0	1.2	10	3	6.0	5.0	19.0	24.0	KC7869
218	16	6.1	5.6	8.0	12.0	1.2	10	4	6.0	6.0	20.0	26.0	KC7870
219	16	8.1	5.6	8.0	16.0	1.2	10	4	8.0	8.0	22.0	30.0	KC7871
220	16	8.1	5.6	8.0	18.0	1.2	10	4	10.0	9.0	24.0	33.0	KC7872

COPPER FORK HOOK TERMINAL ENDS

- Copper IS - 1897
- Electro Tinned finish

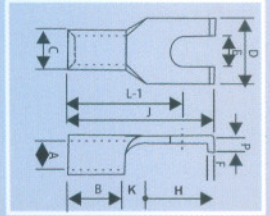

Item No.	AREA mm ²	E	A	C	D	F	B	K	H	L-1	J	P	KAYCEE CAT. No.
221	0.75	2.3	0.9	1.9	4.6	0.5	3	---	5.0	8.0	11	1.2	KC 7279
222	1.5	2.3	1.6	3.2	6.0	0.8	5	---	5.2	3.2	13	1.0	KC 7278
223	1.5	2.3	1.6	3.2	4.6	0.8	5	---	5.2	10.2	13	1.0	KC 7265
224	1.5	4.1	1.7	3.3	7.5	0.8	5	---	6.5	11.5	15	2.4	KC 7266
225	1.5	5.1	1.6	3.2	8.0	0.8	5	2	5.0	12.0	18	1.6	KC 7257
226	1.5	6.3	1.6	3.2	12.0	0.8	5	3	5.0	13.0	19	1.6	KC 7270
227	1.5	8.1	1.6	3.2	12.0	0.8	5	3	5.0	13.0	19	1.6	KC 7271
228	2.5	3.6	2.3	3.9	6.5	0.8	5	2	3	10	15	1.6	KC 7258
229	2.5	4.1	2.3	3.9	7.7	0.8	5	2	3	10	16	1.6	KC 7259
230	2.5	6.3	2.3	3.9	12.0	0.8	5	3	5	13	19	1.6	KC 7272
231	2.5	8.1	2.3	3.9	12.0	0.8	5	3	5	13	19	1.6	KC 7273
232	2.5	5.1	2.3	3.9	10.0	0.8	5	2	5	12	18	1.6	KC 7260
233	4.0	4.1	3.1	5.5	10.0	1.2	6	3	5	14	20	2.0	KC 7274
234	4.0	5.1	3.1	5.5	10.0	1.2	6	3	5	14	20	2.0	KC 7275
235	4.0	6.3	3.1	5.5	12.0	1.2	6	3	5	14	20	2.0	KC 7276
236	4.0	8.1	3.1	5.5	12.0	1.2	6	3	5	14	20	2.0	KC 7277
237	4-6	4.1	3.5	5.5	10.0	1.0	6	3	3	12	18	2.0	KC 7261
238	4-6	5.1	3.5	5.5	10.0	1.0	6	3	5	14	20	2.0	KC 7262
239	4-6	5.1	3.5	5.5	12.0	1.0	6	3	5	14	20	2.0	KC 7263
240	4-6	4.1	3.5	5.5	8.0	1.0	6	2	5	13	17	2.0	KC 7268
241	4-6	5.1	3.5	5.5	8.0	1.0	6	2	5	13	17	2.0	KC 7269
242	6.0	4.1	3.9	5.9	10.0	1.0	6	4	3	13	19	2.0	KC 7264
243	6.0	4.1	3.9	5.9	10.0	1.0	6	---	8.5	14.5	20.5	1.5	KC 7267

COPPER PIN TYPE TERMINAL ENDS FOR SOLDERLESS CRIMPING TO COPPER/ALUMINIUM CONDUCTORS SUITABLE FOR CONTACTORS SWITCHES AND TERMINAL BLOCKS.

- Copper IS - 1897
- Electro Tinned finish

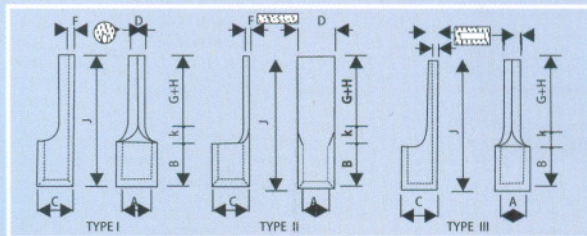

Item No.	AREA mm ²	CZBLE SIZE	A	C	D	F	E	B	K	G+H	J	TYPE	KAYCEE CAT. No.
244	1.5	1/1.40	1.6	3.2	1.9	0.8	---	5	2.0	10	17	I	KCP-9
245	1.5	1/1.40	1.6	3.2	3.1	0.8	---	5	2.0	10	17	II	KCP-35
246	1.5	1/1.50	1.8	3.2	1.9	0.8	---	5	2.0	10	17	I	KCP-38
247	2.5	3/1.06	2.3	3.9	1.9	0.8	---	5	2.0	10	17	I	KCP-1
248	2.5	3/1.06	2.3	3.9	3.1	0.8	---	5	2.0	10	17	II	KCP-2
249	4.0	7/0.85	2.9	4.9	2.7	1.0	---	6	4.0	10	20	I	KCP-3
250	4.0	7/1.06	3.6	5.6	5.1	1.0	---	6	4.0	10	20	II	KCP-4
251	6.0	7/1.06	3.6	5.6	2.7	1.0	---	6	4.0	10	20	I	KCP-5
252	6.0	7/1.2	4.0	6.0	2.7	1.0	---	6	4.0	10	20	I	KCP-6
253	10.0	7/1.4	4.5	6.7	4.3	1.1	2.4	8	2.0	12	22	III	KCP-7
254	16.0	7/1.7	5.8	8.2	5.5	1.2	2.6	10	3.0	13	26	III	KCP-8
255	2.5	---	2.4	4.0	1.7	0.8	1.7	4.2	1.8	8.4	14.4	I	KCP-10
256	2.5	---	2.4	4.0	3.1	0.8	---	4.2	1.8	8.4	14.4	II	KCP-11
257	4.0	1.7	2.8	4.4	1.7	0.8	1.7	4.2	1.8	8.4	14.4	I	KCP-12
258	4.0	---	2.8	4.4	3.1	0.8	---	4.2	1.8	8.4	14.4	II	KCP-13
259	6.0	2.6	3.5	5.5	2.6	1.0	2.6	6.4	1.6	12.4	20.4	I	KCP-14
260	6.0	---	3.5	5.5	5.1	1.0	---	6.4	1.6	12.4	20.4	II	KCP-15
261	10.0	2.6	4.4	6.4	2.6	1.0	2.6	6.4	1.6	12.4	20.4	I	KCP-16
262	25.0	7/2.24	7.5	11.1	7.2	1.8	3.8	11.0	7.0	15	33	III	KCP-125
263	35.0	7/2.5	9.0	12.6	8.2	1.8	3.8	12.0	6.0	15	33	III	KCP-135
264	50.0	19/1.8	10.5	14.1	9.0	1.8	3.8	16.0	8.0	17	41	III	KCP-150
265	70.0	19/2.24	12.0	16.0	10.0	2.0	4.1	16.0	14.0	16	46	III	KCP-170
266	95.0	19/2.5	13.5	18.1	10.0	2.3	4.8	20.0	11.0	20	51	III	KCP-195

**COPPER RECTANGULAR TONGUE FORK TERMINAL ENDS
FOR SOLDERLESS CRIMPING TO COPPER / ALUMINIUM
CONDUCTORS**

- Copper IS - 1897
- Electro Tinned finish

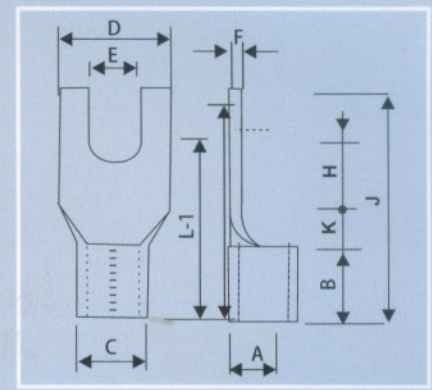

Item No.	AREA mm ²	E	A	C	D	F	B	K	H	L-1	J-1	KAYCEE CAT. No.
267	1.5	3.0	2.0	2.8	6.2	0.4	5	2.4	3.1	10.5	13	KC8055
268	1.5	3.5	1.6	3.2	6.8	0.8	5	---	4.8	8.8	15	KC7249
269	1.5	3.0	2.0	2.8	6.2	0.4	5	2.4	3.1	10.5	13	KC7250
270	2.5	3.5	2.3	3.9	6.5	0.8	5	2.5	4.3	11.8	15	KC7251
271	2.5	5.0	2.6	4.6	10.6	1.0	6.2	---	6.2	12.4	21	KC7280
272	4-6	3.1	3.5	5.5	6.0	1.0	6	---	5.5	11.5	15	KC7252
273	4-6	3.5	3.5	5.5	6.0	1.0	6	---	5.0	11.0	15	KC7253
274	10	6.5	4.5	6.9	16.0	1.2	8	---	11.0	19.0	27	KC7254
275	10	8.2	4.5	6.9	16.0	1.2	8	---	11.0	19.0	27	KC7255

**COPPER PIN TYPE TERMINAL ENDS (INSULATED)
FOR SOLDERLESS CRIMPING TO COPPER / ALUMINIUM
CONDUCTORS.**

Colour Coding of Insulation Sleeve

Size (mm ²)	Colour
1.5	Red
2.5	Blue
4-6	Yellow

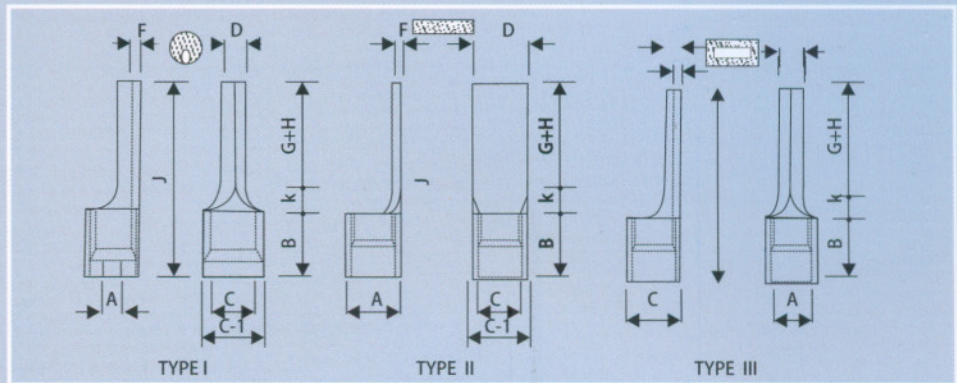

Item No.	AREA mm ²	A	C	D	F	E	B	G+H	J	C-1	J-1	TYPE	KAYCEE CAT. No.
276	1.5	1.6	3.2	1.9	0.8	---	5	10	17	4.8	10	I	KCPI-17
277	1.5	1.6	3.2	3.1	0.8	---	5	10	17	4.8	10	II	KCPI-40
278	1.5	1.8	3.3	1.5	0.75	---	5	15	22	4.8	10	I	KCPI-42
279	1.5	1.5	3.2	1.7	0.8	---	5	10	17	4.8	10	I	KCPI-51
280	2.5	2.3	3.9	1.9	0.8	---	5	10	17	5.5	10	I	KCPI-18
281	2.5	2.3	3.9	3.1	0.8	---	5	10	17	5.5	10	II	KCPI-19
282	4.0	2.9	4.9	2.7	1.0	---	6	10	20	7.1	14	I	KCPI-20
283	4.0	3.6	5.6	5.1	1.0	---	6	10	20	7.1	14	II	KCPI-21
284	6.0	3.6	5.6	2.7	1.0	---	6	10	20	7.1	14	I	KCPI-22
285	6.0	4.0	6.0	2.7	1.0	---	6	10	20	7.1	14	I	KCPI-23
286	10.0	4.5	6.7	4.3	1.1	2.4	8	12	22	7.9	16	III	KCPI-24
287	16.0	5.8	8.2	5.5	1.2	2.6	10	13	26	10.0	20	III	KCPI-25

**COPPER RING TONGUE TERMINAL FORK ENDS ("U" CUT INSULATED)
FOR SOLDERLESS CRIMPING TO COPPER/ALUMINIUM CONDUCTORS.**

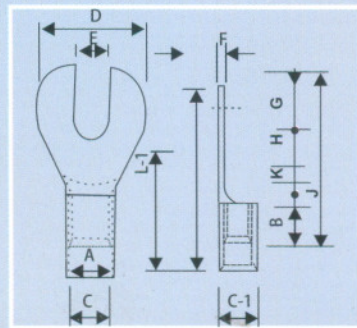

Colour Coding of Insulation Sleeve

Size (mm ²)	Colour
1.5	Red
2.5	Blue
4-6	Yellow

Item No.	AREA mm ²	E	A	C	D	F	B	K	H	G	J	J-1	C-1	L-3	KAYCEE CAT. No.
288	1.5	3.1	1.6	3.2	6.0	0.8	5	2	4.0	3.0	14.0	10	4.8	16	KC7873
289	1.5	3.6	1.6	3.2	6.0	0.8	5	2	4.0	3.0	14.0	10	4.8	16	KC7874
290	1.5	3.1	1.6	3.2	6.8	0.8	5	---	4.6	3.4	13.0	10	4.8	14.6	KC7875
291	1.5	3.6	1.6	3.2	6.8	0.8	5	---	4.6	3.4	13.0	10	4.8	14.6	KC7876
292	1.5	4.1	1.6	3.2	7.0	0.8	5	1	5.0	3.5	14.0	10	4.8	16	KC7877
293	1.5	4.1	1.6	3.2	8.0	0.8	5	2	5.0	4.0	16.0	10	4.8	17	KC7878
294	1.5	5.1	1.6	3.2	10.0	0.8	5	2	6.0	5.0	18.0	10	4.8	18	KC7879
295	1.5	6.1	1.6	3.2	10.0	0.8	5	2	6.0	5.0	18.0	10	4.8	18	KC7880
296	2.5	3.1	2.3	3.9	6.5	0.8	5	1	3.5	3.2	12.7	10	5.5	14.5	KC7881
297	2.5	3.6	2.3	3.9	6.5	0.8	5	1	3.5	3.2	12.7	10	5.5	14.5	KC7882
298	2.5	4.1	2.3	3.9	8.0	0.8	5	2	5.0	4.0	16.0	10	5.5	17	KC7883
299	2.5	5.1	2.3	3.9	10.0	0.8	5	1	7.0	5.0	18.0	10	5.5	18	KC7884
300	2.5	6.1	2.3	3.9	10.0	0.8	5	1	7.0	5.0	18.0	10	5.5	18	KC7885
301	4-6	4.1	3.5	5.5	8.0	1.0	6	2	5.0	4.0	17.0	14	7.1	21	KC7886
302	4-6	4.1	3.5	5.5	10.0	1.0	6	3	5.0	5.0	19.0	14	7.1	22	KC7887
303	4-6	5.1	3.5	5.5	10.0	1.0	6	3	5.0	5.0	19.0	14	7.1	22	KC7888
304	4-6	5.1	3.5	5.5	12.0	1.0	6	3	7.0	6.0	22.0	14	7.1	24	KC7889
305	4-6	6.1	3.5	5.5	12.0	1.0	6	3	7.0	6.0	22.0	14	7.1	24	KC7890
306	10	4.1	4.3	6.3	10.0	1.0	8	2	7.0	5.0	22.0	16	7.9	25	KC7891
307	10	5.1	4.3	6.3	10.0	1.0	8	2	7.0	5.0	22.0	16	7.9	25	KC7892
308	10	6.1	4.3	6.3	12.0	1.0	8	2	7.0	6.0	23.0	16	7.9	25	KC7893
309	10	8.1	4.3	6.3	16.0	1.0	8	4	7.0	8.0	27.0	16	7.9	27	KC7894
310	16	5.1	5.6	8.0	10.0	1.2	10	3	6.0	5.0	24.0	20	10.0	29	KC7895
311	16	6.1	5.6	8.0	12.0	1.2	10	4	6.0	6.0	26.0	20	10.0	30	KC7896
312	16	8.1	5.6	8.0	16.0	1.2	10	4	8.0	8.0	30.0	20	10.0	32	KC7897
313	16	8.1	5.6	8.0	18.0	1.2	10	4	10.0	9.0	33.0	20	10.0	34	KC7898

**COPPER RECTANGULAR TONGUE FORK TERMINAL ENDS (INSULATED)
FOR SOLDERLESS CRIMPING TO COPPER OR ALUMINIUM CONDUCTORS.**

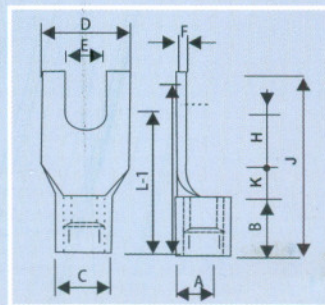

Colour Coding of Insulation Sleeve

Size (mm ²)	Colour
1.5	Red
2.5	Blue
4-6	Yellow

Item No.	AREA mm ²	E	A	C	D	F	B	K	H	J	C-1	J-1	L-3	KAYCEE CAT. No.
314	1.5	5.1	1.6	3.2	8.0	0.8	5	2.0	10.0	21	4.8	10	27.0	KC7925
315	1.5	3.5	1.6	3.2	6.8	0.8	5	-	4.8	15	4.8	10	20.8	KC7926
316	1.5	3.0	2.0	2.8	6.2	0.4	5	2.4	3.1	13	4.8	10	20.5	KC7927
317	2.5	3.5	2.3	3.9	6.5	0.8	5	2.5	4.3	15	5.5	10	21.8	KC7928
318	2.5	5.0	2.6	4.6	10.6	1.6	6.2	-	6.2	21	5.5	10	20.0	KC7929
319	4-6	3.1	3.5	5.5	6.0	1.0	6	---	5.5	15	7.1	14	27.5	KC7930
320	4-6	3.5	3.5	5.5	6.0	1.0	6	---	5.0	15	7.1	14	27.0	KC7931
321	10	6.5	4.5	6.9	16.0	1.2	8	---	11.0	27	7.9	16	35.0	KC7932
322	10	8.2	4.5	6.9	16.0	1.2	8	---	11.0	27	7.9	16	35.0	KC7933

**COPPER RING TONGUE TERMINAL ENDS (INSULATED)
FOR SOLDERLESS CRIMPING
TO COPPER / ALUMINIUM CONDUCTORS.**

Colour Coding of Insulation Sleeve

Size (mm ²)	Colour
1.5	Red
2.5	Blue
4-6	Yellow

- Copper IS - 1897
- Electro Tinned finish

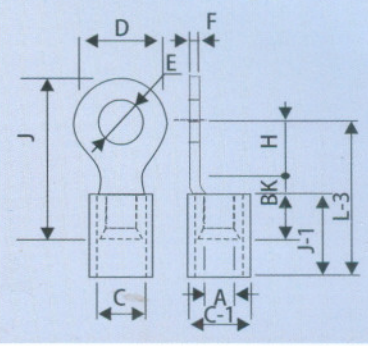

Item No.	AREA mm ²	E	A	C	D	F	B	K	H	J	J-1	L-3	C-1	KAYCEE CAT. No.
323	1.5	2.2	1.6	3.2	6	0.8	5	2	4	14	10	16	4.8	KC 7052
324	1.5	2.6	1.6	3.2	6	0.8	5	2	4	14	10	16	4.8	KC 7053
325	1.5	3.2	1.6	3.2	6	0.8	5	2	4	14	10	16	4.8	KC 7054
326	1.5	3.2	1.6	3.2	6.8	0.8	5	1	3.6	13	10	14.6	4.8	KC 7057
327	1.5	3.2	1.6	3.2	8	0.8	5	2	5	16	10	17	4.8	KC 7060
328	1.5	3.7	1.6	3.2	6	0.8	5	2	4	14	10	16	4.8	KC 7055
329	1.5	3.7	1.6	3.2	6.8	0.8	5	1	3.6	13	10	14.6	4.8	KC 7058
330	1.5	4.2	1.6	3.2	6	0.8	5	2	4	14	10	16	4.8	KC 7056
331	1.5	4.2	1.6	3.2	6.8	0.8	5	1	3.6	13	10	14.6	4.8	KC 7059
332	1.5	4.2	1.6	3.2	8	0.8	5	2	5	16	10	17	4.8	KC 7061
333	1.5	4.2	1.6	3.2	10	0.8	5	2	6	18	10	18	4.8	KC 7064
334	1.5	4.2	1.6	3.2	7	0.8	5	1	5	14.5	10	16	4.8	KC 7063
335	1.5	5.2	1.6	3.2	8	0.8	5	2	5	16	10	17	4.8	KC 7062
336	1.5	5.2	1.6	3.2	10	0.8	5	2	6	18	10	18	4.8	KC 7065
337	1.5	6.4	1.6	3.2	10	0.8	5	2	6	18	10	18	4.8	KC 7066
338	1.5	6.4	1.6	3.2	12	0.8	5	1	6	18	10	17	4.8	KC 7067
339	2.5	3.2	2.3	3.9	6.5	0.8	5	1	3.5	12.7	10	14.5	5.5	KC 7068
340	2.5	3.7	2.3	3.9	6.5	0.8	5	1	3.5	12.7	10	14.5	5.5	KC 7069
341	2.5	3.7	2.3	3.9	8	0.8	5	2	5	16	10	17	5.5	KC 7070
342	2.5	4.2	2.3	3.9	8	0.8	5	2	5	16	10	17	5.5	KC 7071
343	2.5	5.2	2.3	3.9	8	0.8	5	2	5	16	10	17	5.5	KC 7072
344	2.5	5.2	2.3	3.9	10	0.8	5	1	7	18	10	18	5.5	KC 7073
345	2.5	5.2	2.3	3.9	12	0.8	5	2	9	22	10	21	5.5	KC 7075
346	2.5	8.2	2.3	3.9	12	0.8	5	2	9	22	10	21	5.5	KC 7077
347	2.5	6.4	2.3	3.9	10	0.8	5	1	7	18	10	18	5.5	KC 7074
348	2.5	6.4	2.3	3.9	12	0.8	5	2	9	22	10	21	5.5	KC 7076
349	2.5	8.2	2.3	3.9	16	0.8	5	2	10	25	10	22	5.5	KC 7079
350	2.5	6.4	2.3	3.9	16	0.8	5	2	10	25	10	22	5.5	KC 7078
351	2.5	10.2	2.3	3.9	16	0.8	5	2	10	25	10	22	5.5	KC 7080
352	2.5	10.2	2.3	3.9	18	0.8	5	1	14	29	10	25	5.5	KC 7081
353	2.5	12.7	2.3	3.9	18	0.8	5	1	14	29	10	25	5.5	KC 7082
354	4-6	4.2	3.5	5.5	8	1.0	6	2	5	17	14	21	7.1	KC 7083
355	4-6	4.2	3.5	5.5	10	1.0	6	3	5	19	14	22	7.1	KC 7085
356	4-6	5.2	3.5	5.5	8	1.0	6	2	5	17	14	21	7.1	KC 7084
357	4-6	5.2	3.5	5.5	10	1.0	6	3	5.0	19.0	14	22.0	7.1	KC 7086
358	4-6	5.2	3.5	5.5	8	1.0	6	3	9.0	22.0	14	26.0	7.1	KC 7087
359	4-6	5.2	3.5	5.5	12	1.0	6	2	6	20	14	22	7.1	KC 7088
360	4-6	5.2	3.5	5.5	12	1.0	6	3	7	22	14	24	7.1	KC 7091
361	4-6	6.4	3.5	5.5	12	1.0	6	2	6.0	20.0	14	22.0	7.1	KC 7089
362	4-6	6.4	3.5	5.5	12	1.0	6	3	7.0	22.0	14	24.0	7.1	KC 7092
363	4-6	6.4	3.5	5.5	14	1.0	6	2	10.5	25.5	14	26.5	7.1	KC 7093
364	4-6	6.4	3.5	5.5	16	1.0	6	3	13.0	30.0	14	30.0	7.1	KC 7096
365	4-6	6.4	3.5	5.5	18	1.0	6	3	12.0	30.0	14	29.0	7.1	KC 7099
366	4-6	8.2	3.5	5.5	14	1.0	6	2	10.5	25.5	14	26.5	7.1	KC 7094
367	4-6	8.2	3.5	5.5	12	1.0	6	2	6.0	20.0	14	22.0	7.1	KC 7090.
368	4-6	8.2	3.5	5.5	18	1.0	6	3	12.0	30.0	14	29.0	7.1	KC 7100
369	4-6	8.2	3.5	5.5	18	1.0	6	3	12	30	14	30	7.1	KC 7098
370	4-6	9.7	3.5	5.5	14	1.0	6	2	10.5	25.5	14	26.5	7.1	KC 7095
371	4-6	10.2	3.5	5.5	16	1.0	6	3	13	30	14	30	7.1	KC 7097

COPPER FORK HOOK TERMINAL ENDS (INSULATED)

Colour Coding of Insulation Sleeve

Size (mm ²)	Colour
0.75	Yellow
1.5	Red
2.5	Blue
4-6	Yellow

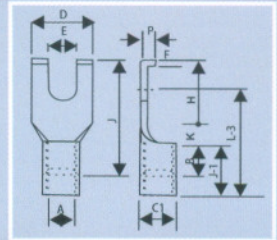

Item No.	AREA mm ²	E	A	C	D	F	B	K	H	J	J-1	A-1	C-1	L-3	KAYCEE CAT. No.
372	0.75	2.3	0.9	1.9	4.6	0.5	3	---	5	11	1.2	3.2	8	13.0	KC 7943
373	1.5	2.3	1.6	3.2	6.0	0.8	5	---	5.2	13	1.0	4.8	10	20.2	KC 7944
374	1.5	2.3	1.6	3.2	4.6	0.8	5	---	5.2	13	1.0	4.8	10	20.0	KC 7945
375	1.5	4.1	1.7	3.3	7.5	0.8	5	---	6.5	15	2.4	4.8	10	21.5	KC 7946
376	1.5	3.5	1.6	3.2	6.8	0.8	5	2	3	15	1.6	4.8	10	20.0	KC 7947
377	1.5	5.1	1.6	3.2	8.0	0.8	5	2	5	18	1.6	4.8	10	22.0	KC 7948
378	1.5	6.3	1.6	3.2	12.0	0.8	5	3	5	19	1.6	4.8	10	23.0	KC 7949
379	1.5	8.1	1.6	3.2	12.0	0.8	5	3	5	19	1.6	4.8	10	23.0	KC 7950
380	2.5	3.6	2.3	3.9	6.5	0.8	5	2	3	15	1.6	5.5	10	20.0	KC 7951
381	2.5	4.1	2.3	3.9	7.7	0.8	5	2	3	16	1.6	5.5	10	20.0	KC 7952
382	2.5	5.1	2.3	3.9	10.0	0.8	5	2	5	18	1.6	5.5	10	22.0	KC 7953
383	2.5	6.3	2.3	3.9	12.0	0.8	5	3	5	19	1.6	5.5	10	23.0	KC 7954
384	2.5	8.1	2.3	3.9	12.0	0.8	5	3	5	19	1.6	5.5	10	23.0	KC 7955
385	4-6	4.1	3.1	5.5	10.0	1.2	6	3	5	20	2.0	7.1	14	30.0	KC 7956
386	4-6	4.1	3.5	5.5	10.0	1.0	6	3	3	18	2.0	7.1	14	28.0	KC 7960
387	4-6	4.1	3.5	5.5	8.0	1.0	6	2	5	17	2.0	7.1	14	29.0	KC 7963
388	4-6	5.1	3.5	5.5	8.0	1.0	6	2	5	17	2.0	7.1	14	29.0	KC 7964

COPPER RING TONGUE FORK TERMINAL ENDS ("U" CUT INSULATED WITH METAL REINFORCEMENT) FOR SOLDERLESS CRIMPING TO COPPER/ALUMINIUM CONDUCTORS

Colour Coding of Insulation Sleeve

Size (mm ²)	Colour
1.5	Red
2.5	Blue
4-6	Yellow

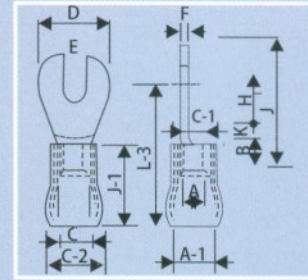

Item No.	AREA mm ²	E	A	C	D	F	B	K	H	J	J-1	A-1	C-1	C-2	L-3	KAYCEE CAT. No.
389	1.5	3.1	1.6	3.2	6	0.8	5	2	4	14	10	3.6	4.8	5.4	16	KC7899
390	1.5	3.1	1.6	3.2	6.8	0.8	5	-	4.6	13	10	3.6	4.8	5.4	14.6	KC7901
391	1.5	3.6	1.6	3.2	6	0.8	5	2	4	14	10	3.6	4.8	5.4	16	KC7900
392	1.5	3.6	1.6	3.2	6.8	0.8	5	-	4.6	13	10	3.6	4.8	5.4	14.6	KC7902
393	1.5	4.1	1.6	3.2	7	0.8	5	1	5	14	10	3.6	4.8	5.4	16	KC7903
394	1.5	4.1	1.6	3.2	8	0.8	5	2	5	16	10	3.6	4.8	5.4	17	KC7904
395	1.5	5.1	1.6	3.2	10	0.8	5	2	6	18	10	3.6	4.8	5.4	18	KC7905
396	1.5	6.1	1.6	3.2	10	0.8	5	2	6	18	10	3.6	4.8	5.4	18	KC7906
397	2.5	3.1	2.3	3.9	6.5	0.8	5	1	3.5	12.7	10	4.4	5.4	6.0	14.5	KC7907
398	2.5	3.6	2.3	3.9	6.5	0.8	5	1	3.5	12.7	10	4.4	5.4	6.0	14.5	KC7908
399	2.5	4.1	2.3	3.9	8	0.8	5	2	5	16	10	4.4	5.4	6.0	17	KC7909
400	2.5	5.1	2.3	3.9	10	0.8	5	1	7	18	10	4.4	5.4	6.0	18	KC7910
401	2.5	6.1	2.3	3.9	10	0.8	5	1	7	18	10	4.4	5.4	6.0	18	KC7911
402	4-6	4.1	3.5	5.5	8	1.0	6	2	5	17	15	6.4	7.1	8.6	22	KC7912
403	4-6	4.1	3.5	5.5	10	1.0	6	3	5	19	15	6.4	7.1	8.6	23	KC7913
404	4-6	5.1	3.5	5.5	10	1.0	6	3	5	19	15	6.4	7.1	8.6	23	KC7914
405	4-6	5.1	3.5	5.5	12	1.0	6	3	7	22	15	6.4	7.1	8.6	25	KC7915
406	4-6	6.1	3.5	5.5	12	1.0	6	3	7	22	15	6.4	7.1	8.6	25	KC7916
407	10	4.1	4.3	6.3	10	1.0	8	2	7	22	17	6.8	8.3	9.5	26	KC7917
408	10	5.1	4.3	6.3	10	1.0	8	2	7	22	17	6.8	8.3	9.5	26	KC7918
409	10	6.1	4.3	6.3	12	1.0	8	2	7	23	17	6.8	8.3	9.5	26	KC7919
410	10	8.1	4.3	6.3	16	1.0	8	4	7	27	17	6.8	8.3	9.5	28	KC7920
411	16	5.1	5.6	8.0	10	1.2	10	3	6	24	23	10.9	9.9	12.9	32	KC7921
412	16	6.1	5.6	8.0	12	1.2	10	4	6	26	23	10.9	9.9	12.9	33	KC7922
413	16	8.1	5.6	8.0	16	1.2	10	4	8	30	23	10.9	9.9	12.9	35	KC7923
414	16	8.1	5.6	8.0	18	1.2	10	4	10	33	23	10.9	9.9	12.9	37	KC7924

**COPPER RING TONGUE TERMINAL ENDS
(INSULATED WITH METAL REINFORCEMENT)
FOR SOLDERLESS CRIMPING TO COPPER OR ALUMINIUM CONDUCTORS.**

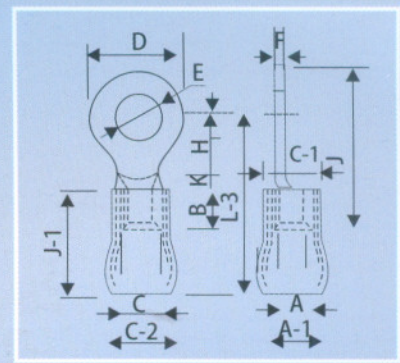

Colour Coding of Insulation Sleeve

Size (mm ²)	Colour
1.5	Red
2.5	Blue
4-6	Yellow

- Copper IS - 1897
- Electro Tinned finish

Item No.	AREA mm ²	E	A	C	D	F	B	K	H	J	J-1	A-1	C-1	C-2	L-3	KAYCEE CAT. No.
415	1.5	2.2	1.6	3.2	6.0	0.8	5	2	4.0	14.0	10	3.6	4.8	5.4	16.0	KC 7435
416	1.5	2.6	1.6	3.2	6.0	0.8	5	2	4.0	14.0	10	3.6	4.8	5.4	16.0	KC 7436
117	1.5	3.2	1.6	3.2	6.0	0.8	5	2	4.0	14.0	10	3.6	4.8	5.4	16.0	KC 7437
418	1.5	3.2	1.6	3.2	6.8	0.8	4	1	3.0	11.4	10	3.6	4.8	5.4	14.6	KC 7440
419	1.5	3.2	1.6	3.2	8.0	0.8	5	2	5.0	16.0	10	3.6	4.8	5.4	17.0	KC 7443
420	1.5	3.7	1.6	3.2	6.0	0.8	5	2	4.0	14.0	10	3.6	4.8	5.4	16.0	KC 7438
421	1.5	3.7	1.6	3.2	6.8	0.8	4	1	3.0	11.4	10	3.6	4.8	5.4	14.6	KC 7441
422	1.5	4.2	1.6	3.2	6.0	0.8	5	2	4.0	14.0	10	3.6	4.8	5.4	16.0	KC 7439
423	1.5	4.2	1.6	3.2	6.8	0.8	4	1	3.0	11.4	10	3.6	4.8	5.4	14.6	KC 7442
424	1.5	4.2	1.6	3.2	8.0	0.8	5	2	5.0	16.0	10	3.6	4.8	5.4	17.0	KC 7444
425	1.5	4.2	1.6	3.2	10.0	0.8	5	2	6.0	18.0	10	3.6	4.8	5.4	18.0	KC 7447
426	1.5	4.2	1.6	3.2	7.0	0.8	5	1	5.0	14.5	10	3.6	4.8	5.4	16.0	KC 7446
427	1.5	5.2	1.6	3.2	8.0	0.8	5	2	5.0	16.0	10	3.6	4.8	5.4	17.0	KC 7445
428	1.5	5.2	1.6	3.2	10.0	0.8	5	2	6.0	18.0	10	3.6	4.8	5.4	18.0	KC 7448
429	1.5	6.4	1.6	3.2	10.0	0.8	5	2	6.0	18.0	10	3.6	4.8	5.4	18.0	KC 7449
430	1.5	6.4	1.6	3.2	12.0	0.8	5	1	6.0	18.0	10	3.6	4.8	5.4	17.0	KC 7450
431	2.5	3.2	2.3	3.9	6.5	0.8	5	1	3.5	12.7	10	4.4	5.4	6.0	17.7	KC 7451
432	2.5	3.7	2.3	3.9	6.5	0.8	5	1	3.5	12.7	10	4.4	5.4	6.0	17.7	KC 7452
433	2.5	3.7	2.3	3.9	8.0	0.8	5	2	5.0	16.0	10	4.4	5.4	6.0	17.0	KC 7453
434	2.5	4.2	2.3	3.9	8.0	0.8	5	2	5.0	16.0	10	4.4	5.4	6.0	17.0	KC 7454
435	2.5	5.2	2.3	3.9	8.0	0.8	5	2	5.0	16.0	10	4.4	5.4	6.0	17.0	KC 7455
436	2.5	5.2	2.3	3.9	10.0	0.8	5	1	7.0	18.0	10	4.4	5.4	6.0	18.0	KC 7456
437	2.5	6.4	2.3	3.9	10.0	0.8	5	1	7.0	18.0	10	4.4	5.4	6.0	18.0	KC 7457
438	2.5	6.4	2.3	3.9	12.0	0.8	5	2	9.0	22.0	10	4.4	5.4	6.0	21.0	KC 7459
439	2.5	5.2	2.3	3.9	12.0	0.8	5	2	9.0	22.0	10	4.4	5.4	6.0	21.0	KC 7458
440	2.5	6.4	2.3	3.9	16.0	0.8	5	2	10.0	25.0	10	4.4	5.4	6.0	22.0	KC 7461
441	2.5	8.2	2.3	3.9	12.0	0.8	5	2	9.0	22.0	10	4.4	5.4	6.0	21.0	KC 7460
442	2.5	8.2	2.3	3.9	16.0	0.8	5	2	10.0	25.0	10	4.4	5.4	6.0	22.0	KC 7462
443	2.5	10.2	2.3	3.9	16.0	0.8	5	2	10.0	25.0	10	4.4	5.4	6.0	22.0	KC 7463
444	2.5	10.2	2.3	3.9	18.0	0.8	5	1	14.0	29.0	10	4.4	5.4	6.0	25.0	KC 7464
445	2.5	10.2	2.3	3.9	16	0.8	5	2	10.0	17.0	10	4.4	5.4	6.0	25.0	KC 7015
446	2.5	12.7	2.3	3.9	18.0	0.8	5	1	14.0	29.0	10	4.4	5.4	6.0	25.0	KC 7465
447	4-6	4.2	3.5	5.5	8.0	1.0	6	2	5.0	17.0	15	6.4	7.1	8.6	22.0	KC 7466
448	4-6	4.2	3.5	5.5	10.0	1.0	6	3	5.0	19.0	15	6.4	7.1	8.6	23.0	KC 7468
449	4-6	5.2	3.5	5.5	8.0	1.0	6	2	5.0	17.0	15	6.4	7.1	8.6	22.0	KC 7467
450	4-6	5.2	3.5	5.5	10.0	1.0	6	3	5.0	19.0	15	6.4	7.1	8.6	23.0	KC 7469
451	4-6	5.2	3.5	5.5	8.0	1.0	6	3	9.8	22.8	15	6.4	7.1	8.6	31.8	KC 7470
452	4-6	5.2	3.5	5.5	12.0	1.0	6	2	6.0	22.0	15	6.4	7.1	8.6	23.0	KC 7471
453	4-6	5.2	3.5	5.5	12.0	1.0	6	3	7.0	22.0	15	6.4	7.1	8.6	25.0	KC 7474
454	4-6	6.4	3.5	5.5	12.0	1.0	6	2	6.0	20.0	15	6.4	7.1	8.6	23.0	KC 7472
455	4-6	6.4	3.5	5.5	12.0	1.0	6	3	7.0	22.0	15	6.4	7.1	8.6	25.0	KC 7475
456	4-6	6.4	3.5	5.5	14.0	1.0	6	2	10.5	25.5	15	6.4	7.1	8.6	27.5	KC 7476
457	4-6	12.7	3.5	5.5	18	1.0	6	3	12.0	30.0	15	6.4	7.1	8.6	30.0	KC 7483
458	4-6	8.2	3.5	5.5	12.0	1.0	6	2	6.0	20.0	15	6.4	7.1	8.6	23.0	KC 7473
459	4-6	8.2	3.5	5.5	14.0	1.0	6	2	10.5	25.5	15	6.4	7.1	8.6	27.5	KC 7477
460	4-6	8.2	3.5	5.5	16	1.0	6	3	13.0	30.0	15	6.4	7.1	8.6	31.0	KC 7479
461	4-6	8.2	3.5	5.5	18	1.0	6	3	12.0	30.0	15	6.4	7.1	8.6	30.0	KC 7481
462	4-6	9.7	3.5	5.5	14	1.0	6	2	10.5	25.5	15	6.4	7.1	8.6	27.5	KC 7478
463	4-6	10.2	3.5	5.5	16	1.0	6	3	13.0	30.0	15	6.4	7.1	8.6	31.0	KC 7480
464	4-6	10.2	3.5	5.5	18	1.0	6	3	12.0	30.0	15	6.4	7.1	8.6	30.0	KC 7482

**COPPER RING TONGUE TERMINAL ENDS
(INSULATED WITH METAL REINFORCEMENT)
FOR SOLDERLESS CRIMPING
TO COPPER /ALUMINIUM CONDUCTORS.**

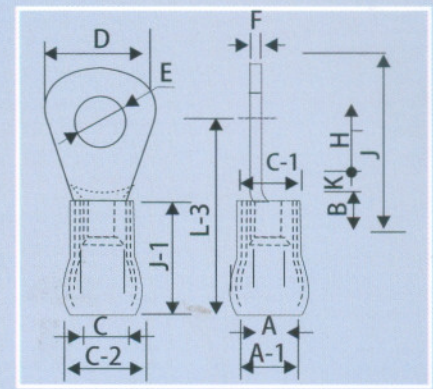

Colour Coding of Insulation Sleeve-Black

- Copper IS - 1897
- Electro Tinned finish

Item No.	AREA mm ²	E	A	C	D	F	B	K	H	J	J-1	A-1	C-1	C-2	L-3	KAYCEE CAT. No.
465	10	4.2	4.3	6.3	10	1.0	8	2	7	22	17	6.8	8.3	9.5	26	KC7484
466	10	5.2	4.3	6.3	10	1.0	8	2	7	22	17	6.8	8.3	9.5	26	KC7486
467	10	4.2	4.3	6.3	10	1.0	8	3	4	20	17	6.8	8.3	9.5	24	KC7485
468	10	5.2	4.3	6.3	10	1.0	8	3	4	20	17	6.8	8.3	9.5	24	KC7487
469	10	6.4	4.3	6.3	12	1.0	8	2	7	23	17	6.8	8.3	9.5	26	KC7488
470	10	8.2	4.3	6.3	16	1.0	8	4	7	27	17	6.8	8.3	9.5	28	KC7489
471	10	8.2	4.3	6.3	18	1.0	8	4	9	30	17	6.8	8.3	9.5	30	KC7490
472	10	10.2	4.3	6.3	18	1.0	8	4	9	30	17	6.8	8.3	9.5	30	KC7491
473	10	10.2	4.3	6.3	22	1.0	8	5	10	34	17	6.8	8.3	9.5	32	KC7492
474	10	12.7	4.3	6.3	22	1.0	8	5	10	34	17	6.8	8.3	9.5	32	KC7493
475	16	5.2	5.6	8.0	10	1.2	10	3	6	24	23	10.9	9.9	12.9	32	KC7494
476	16	5.2	5.6	8.0	12	1.2	10	4	6	26	23	10.9	9.9	12.9	33	KC7495
477	16	6.4	5.6	8.0	12	1.2	10	4	6	26	23	10.9	9.9	12.9	33	KC7496
478	16	6.4	5.6	8.0	16	1.2	10	4	8	30	23	10.9	9.9	12.9	35	KC7497
479	16	8.2	5.6	8.0	16	1.2	10	4	8	30	23	10.9	9.9	12.9	35	KC7498
480	16	9.7	5.6	8.0	16	1.2	10	4	8	30	23	10.9	9.9	12.9	35	KC7499
481	16	8.2	5.6	8.0	18	1.2	10	4	10	33	23	10.9	9.9	12.9	37	KC7500
482	16	10.2	5.6	8.0	18	1.2	10	4	10	33	23	10.9	9.9	12.9	37	KC7501
483	16	10.2	5.6	8.0	22	1.2	10	6	8	35	23	10.9	9.9	12.9	37	KC7502
484	16	12.7	5.6	8.0	22	1.2	10	6	8	35	23	10.9	9.9	12.9	37	KC7503

**COPPER RECTAGULAR FORK TONGUE TERMINAL ENDS
(INSULATED WITH METAL REINFORCEMENT)
FOR SOLDERLESS CRIMPING TO COPPER OR ALUMINIUM CONDUCTORS.**

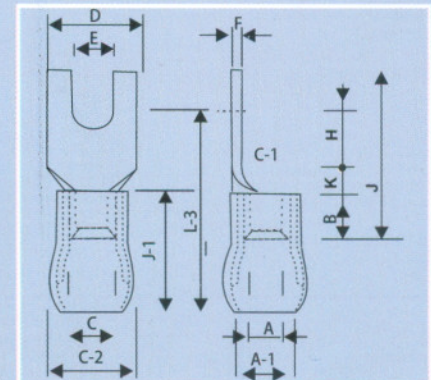

Colour Coding of Insulation Sleeve
Size (mm²) Colour
1.5 Red
2.5 Blue
4-6 Yellow

Item No.	AREA mm ²	E	A	C	D	F	B	K	H	J	J-1	A-1	C-1	L-3	C-2	KAYCEE CAT. No.
485	1.5	5.1	1.6	3.2	8.0	0.8	5	2.0	10.0	21	10	3.6	4.8	22.0	5.4	KC7934
486	1.5	3.5	1.6	3.2	6.8	0.8	5	---	4.8	15	10	3.6	4.8	14.8	5.4	KC7935
487	1.5	3.0	2.0	2.8	6.2	0.4	5	2.4	3.1	13	10	3.6	4.8	15.5	5.4	KC7936
488	2.5	3.5	2.3	3.9	6.5	0.8	5	2.5	4.3	15	10	4.4	5.4	16.8	6.0	KC7937
489	2.5	5.0	2.6	4.6	10.6	1.0	6.2	---	6.2	21	10	4.4	5.4	16.2	6.0	KC7938
490	4-6	3.1	3.5	5.5	6.0	1.0	6	---	5.5	15	15	6.4	7.1	20.5	8.6	KC7939
491	4-6	3.5	3.5	5.5	6.0	1.0	6	---	5.0	15	15	6.4	7.1	20.0	8.6	KC7940
492	10.0	6.5	4.5	6.9	16.0	1.2	8	---	11.0	27	17	6.8	8.3	28.0	9.5	KC7941
493	10.0	8.2	4.5	6.9	16.0	1.2	8	---	11.0	27	17	6.8	8.3	28.0	9.5	KC7942

**COPPER PIN TYPE TERMINAL ENDS
(INSULATED WITH METAL
REINFORCEMENT)
FOR SOLDERLESS CRIMPING
TO COPPER / ALUMINIUM
CONDUCTORS.**

Colour Coding of Insulation Sleeve

Size (mm ²)	Colour
1.5	Red
2.5	Blue
4-6	Yellow

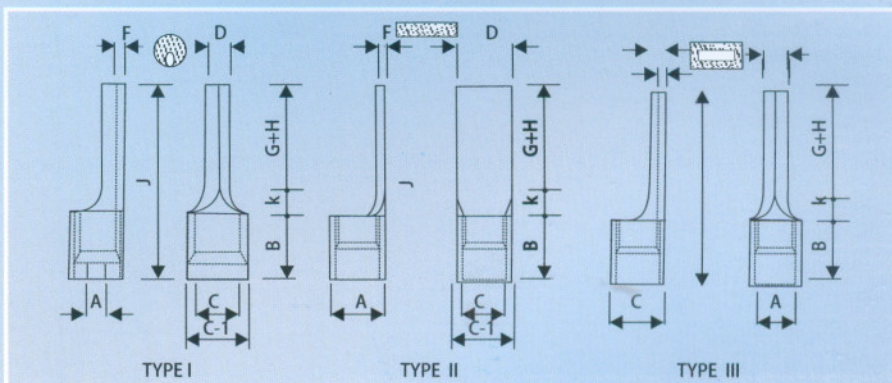

Item No.	AREA mm ²	A	C	D	F	B	G+H	J	J-1	A-1	C-1	C-2	TYPE	KAYCEE CAT. No.
494	1.5	1.6	3.2	1.9	0.8	5	10	17	10	3.6	4.8	5.4	I	KCPD-26
495	2.5	2.3	3.9	1.9	0.8	5	10	17	10	4.4	5.4	6.0	I	KCPD-27
496	2.5	2.3	3.9	3.1	0.8	5	10	17	10	4.4	5.4	6.0	II	KCPD-28
497	4.0	2.9	4.9	2.7	1.0	6	10	20	15	6.4	7.2	8.6	I	KCPD-29
498	4.0	3.6	5.6	5.1	1.0	6	10	20	15	6.4	7.2	8.6	II	KCPD-30
499	6.0	3.6	5.6	2.7	1.0	6	10	20	15	6.4	7.2	8.6	I	KCPD-31
500	6.0	4.0	6.0	2.7	1.0	6	10	20	15	6.4	7.2	8.6	I	KCPD-32
501	2.5	2.3	3.9	1.7	0.8	5	15	22	10	4.4	5.4	6.0	I	KCPD-52
502	10.0	4.5	6.7	4.3	1.1	8	12	22	17	6.8	8.3	9.5	I	KCPD-33
503	16.0	5.8	8.2	5.5	1.2	10	13	26	23	10.9	9.9	12.9	I	KCPD-34

**COPPER FORK HOOK TERMINAL ENDS (INSULATED WITH
METAL REINFORCEMENT)**

Colour Coding of Insulation Sleeve

Size (mm ²)	Colour
0.75	Yellow
1.5	Red
2.5	Blue
4-6	Yellow

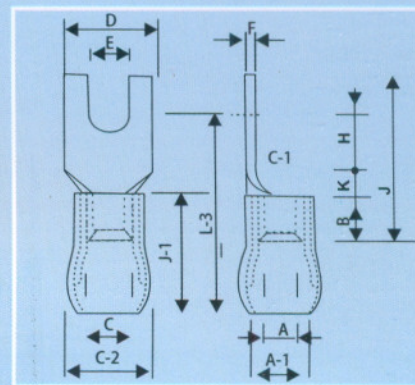

Item No.	AREA mm ²	E	A	C	D	F	B	K	H	J	P	J-1	A-1	C-1	C-2	L-3	KAYCEE CAT. No.
504	0.75	2.3	0.9	1.9	4.6	0.5	3	---	5.0	11	1.2	8	2.2	3.1	3.4	13.0	KC 7967
505	1.5	2.3	1.6	3.2	6.0	0.8	5	---	5.2	13	1.0	10	3.6	4.8	5.4	20.2	KC 7968
506	1.5	2.3	1.6	3.2	4.6	0.8	5	---	5.2	13	1.0	10	3.6	4.8	5.4	20.2	KC 7969
507	1.5	4.1	1.7	3.3	7.5	0.8	5	---	6.5	15	2.4	10	3.6	4.8	5.4	21.5	KC 7970
508	1.5	3.6	1.6	3.2	6.8	0.8	5	2	3	15	1.6	10	3.6	4.8	5.4	20.0	KC 7971
509	1.5	5.1	1.6	3.2	8.0	0.8	5	2	5	18	1.6	10	3.6	4.8	5.4	22.0	KC 7972
510	1.5	6.3	1.6	3.2	12.0	0.8	5	3	5	19	1.6	10	3.6	4.8	5.4	23.0	KC 7973
511	1.5	8.1	1.6	3.2	12.0	0.8	5	3	5	19	1.6	10	3.6	4.8	5.4	23.0	KC 7974
512	2.5	3.6	2.3	3.9	6.5	0.8	5	2	3	15	1.6	10	4.4	5.4	6.0	20.0	KC 7975
513	2.5	4.1	2.3	3.9	7.7	0.8	5	2	3	16	1.6	10	4.4	5.4	6.0	20.0	KC 7976
514	2.5	5.1	2.3	3.9	10.0	0.8	5	2	5	18	1.6	10	4.4	5.4	6.0	22.0	KC 7977
515	2.5	6.3	2.3	3.9	12.0	0.8	5	3	5	19	1.6	10	4.4	5.4	6.0	23.0	KC 7978
516	2.5	8.1	2.3	3.9	12.0	0.8	5	3	3	19	1.6	10	4.4	5.4	6.0	23.0	KC 7979
517	4	4.1	3.1	5.5	10.0	1.2	6	3	5	20	2.0	15	6.4	7.1	8.6	31.0	KC 7980
518	4-6	4.1	3.5	5.5	10.0	1.0	6	3	3	18	2.0	15	6.4	7.1	8.6	29.0	KC 7984
519	4-6	5.1	3.5	5.5	10.0	1.0	6	3	5	20	2.0	15	6.4	7.1	8.6	31.0	KC 7985
520	4-6	4.1	3.5	5.5	8.0	1.0	6	2	5	17	2.0	15	6.4	7.1	8.6	30.0	KC 7987
521	6	5.1	3.5	5.5	8.0	1.0	6	2	5	17	2.0	15	4.4	7.1	8.6	30.0	KC 7988

INSULATED FERRULES

- Copper BS - 1977
- Electro Tinned finish

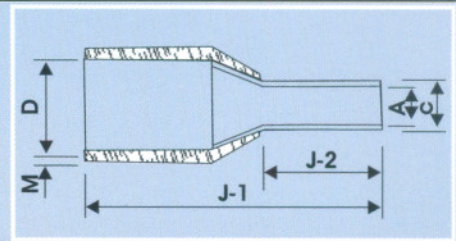

Item No.	SIZE mm ²	COLOUR	J2	A	C	D	M	J1	KAYCEE CAT. No.
522	0.5	WHITE	6	1.1	1.5	2.6	0.5	12	KCO-5-L6
523	0.5	WHITE	8	1.1	1.5	2.6	0.5	14	KCO-5-L8
524	0.5	WHITE	10	1.1	1.5	2.6	0.5	16	KCO-5-L10
525	0.75	BLUE	6	1.5	1.9	2.8	0.5	12	KCO-75-L6
526	0.75	BLUE	8	1.5	1.9	2.8	0.5	14	KCO-75-L8
527	0.75	BLUE	10	1.5	1.9	2.8	0.5	16	KCO-75-L10
528	0.75	BLUE	12	1.5	1.9	2.8	0.5	18	KCO-75-L12
529	1.0	RED	6	1.7	2.1	3.3	0.5	12	KCO-1-L6
530	1.0	RED	8	1.7	2.1	3.3	0.5	14	KCO-1-L8
531	1.0	RED	10	1.7	2.1	3.3	0.5	16	KCO-1-L10
532	1.0	RED	12	1.7	2.1	3.3	0.5	18	KCO-1-L12
533	1.5	BLACK	8	1.9	2.3	3.5	0.5	14	KCO-1.5-L8
534	1.5	BLACK	10	1.9	2.3	3.5	0.5	16	KCO-1.5-L10
535	1.5	BLACK	18	1.9	2.3	3.5	0.5	24	KCO-1.5-L18
536	2.5	GRAY	8	2.4	2.8	4.2	0.5	14	KCO-2.5-L8
537	2.5	GRAY	12	2.4	2.8	4.2	0.5	18	KCO-2.5-L12
538	2.5	GRAY	18	2.4	2.8	4.2	0.5	24	KCO-2.5-L18
539	4	ORANGE	10	2.9	3.3	4.8	0.5	16	KCO-4-L10
540	4	ORANGE	12	2.9	3.3	4.8	0.5	18	KCO-4-L12
541	4	ORANGE	18	2.9	3.3	4.8	0.5	24	KCO-4-L18
542	6	GREEN	10	3.8	4.2	6.3	0.5	18	KCO-6-L10
543	6	GREEN	12	3.8	4.2	6.3	0.5	20	KCO-6-L12
544	6	GREEN	15	3.8	4.2	6.3	0.5	23	KCO-6-L15
545	6	GREEN	18	3.8	4.2	6.3	0.5	26	KCO-6-L18
546	10	BROWN	12	4.7	5.1	7.6	0.7	22	KCO-10-L12
547	10	BROWN	15	4.7	5.1	7.6	0.7	25	KCO-10-L15
548	10	BROWN	18	4.7	5.1	7.6	0.7	28	KCO-10-L18
549	16	WHITE	12	6.0	6.4	8.8	0.7	24	KCO-16-L12
550	16	WHITE	15	6.0	6.4	8.8	0.7	27	KCO-16-L15
551	16	WHITE	18	6.0	6.4	8.8	0.7	30	KCO-16-L18

TWIN CORD END TERMINALS (NEW DEVELOPMENT)

- Copper BS - 1977
- Electro Tinned finish

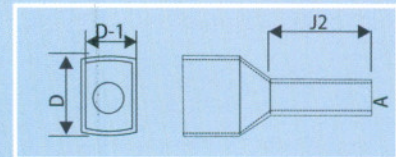

Item No.	AREA mm ²	COLOUR	J2	A	D	KAYCEE CAT. No.
552	0.5	WHITE	8.0	1.5	5.6	KCFTW-5-L8
553	0.75	GREY	8.0	1.8	6.2	KCFTW-75-L8
554	0.75	GREY	10.0	1.8	6.2	KCFTW-75-L10
555	1.0	RED	8.0	2.0	6.0	KCFTW-1-L8
556	1.0	RED	10.0	2.0	6.0	KCFTW-1-L10
557	1.5	BLACK	8.0	2.3	7.2	KCFTW-1.5-L8
558	1.5	BLACK	12.0	2.3	7.2	KCFTW-1.5-L12
559	2.5	BLUE	10.0	2.9	8.5	KCFTW-2.5-L10
560	2.5	BLUE	12.0	2.9	8.5	KCFTW-2.5-L12
561	4.0	GREY	12.0	3.8	9.2	KCFTW-4-L12
562	6.0	YELLOW	14.0	4.9	10.5	KCFTW-6-L14
563	10.0	RED	14.0	6.5	13.0	KCFTW-10-L14
564	16.0	BLUE	14.0	8.3	19.3	KCFTW-16-L14

ALLUMINIUM TUBLER TERMINAL ENDS FOR ALLUMINIUM CONDUCTORS

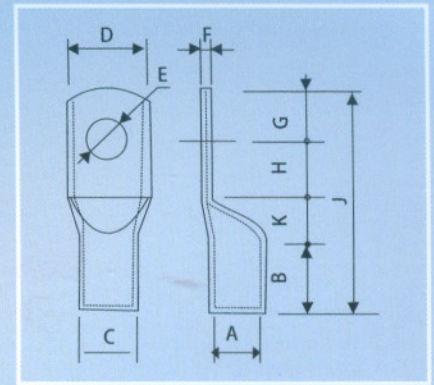

ALLUMINIUM IS : 5082

Item No.	AREA mm ²	CABLE SIZE	E	A	C	D	F	B	K	H	G	J	KAYCEE CAT. No.
565	2.5	1/1.8	3.2	2.0	5.5	6.6	3.5	7	3	4	4	18	KC-ALS-151
566	2.5	3/1.06	3.7	2.6	5.5	7.0	2.9	7	3	4	4	18	KC-ALS-309
567	4	7/0.85	4.2	2.9	5.5	7.2	2.6	7	3	4	4	18	KC-ALS-155
568	4	7/0.85	5.2	2.9	5.5	12.0	1.2	7	3	4	4	24	KC-ALS-317
569	6	7/1.06	5.2	3.5	5.5	7.5	2.0	7	4	7	6	24	KC-ALS-158
570	6	7/1.06	6.5	3.5	5.5	12.0	1.1	7	4	7	6	24	KC-ALS-313
571	10	1/3.55	4.2	3.8	6.2	8.4	2.4	7	4	9	8	28	KC-ALS-159
572	10	7/1.4	6.4	4.4	7.2	9.7	2.8	9	4	9	8	30	KC-ALS-214
573	10	7/1.4	8.2	4.4	7.2	15.0	1.8	9	4	9	8	30	KC-ALS-215
574	16	7/1.7	6.4	5.4	8.3	11.4	2.9	13	4	11	9	37	KC-ALS-252
575	16	7/1.7	8.2	5.4	8.3	11.4	2.9	13	4	11	9	37	KC-ALS-216
576	16	7/1.7	10.2	5.4	8.3	18.0	1.8	13	4	11	9	37	KC-ALS-217
577	25	7/2.24	6.4	7.0	9.7	13.7	2.7	16	7	12	9	44	KC-ALS-253
578	25	7/2.24	8.2	7.0	9.7	13.7	2.7	16	7	12	9	44	KC-ALS-218
579	25	7/2.24	10.2	7.0	9.7	20.0	1.7	16	7	11	10	44	KC-ALS-219
580	25	7/2.24	12.7	7.0	9.7	20.0	1.7	16	7	11	10	44	KC-ALS-220
581	35	7/2.5	6.4	8.0	10.8	15.14	2.8	18	7	11	11	47	KC-ALS-254
582	35	7/2.5	8.2	8.0	10.8	15.14	2.8	18	7	11	11	47	KC-ALS-221
583	35	7/2.5	10.2	8.0	10.8	20.0	2.1	18	7	11	11	47	KC-ALS-222
584	50	19/1.8	8.2	9.3	13	18.3	3.7	22	8	13	11	54	KC-ALS-255
585	50	19/1.8	10.2	9.3	13	23.0	2.8	22	8	13	11	54	KC-ALS-312
586	50	19/1.8	12.7	9.3	13	23.0	2.8	22	8	12	12	54	KC-ALS-224
587	70	19/2.24	8.2	17.6	16	22.6	4.4	26	8	13	13	60	KC-ALS-256
588	70	19/2.24	10.2	11.6	16	22.6	4.4	26	8	13	13	60	KC-ALS-225
589	70	19/2.24	12.7	11.6	16	22.6	4.4	26	8	13	13	60	KC-ALS-226
590	95	19/2.5	10.2	12.9	17.1	24.5	4.2	28	8	14	14	64	KC-ALS-227
591	95	19/2.5	12.7	12.9	17.1	24.5	4.2	28	8	14	14	64	KC-ALS-228
592	95	19/2.5	16.2	12.9	17.1	24.5	4.2	28	8	14	14	64	KC-ALS-229
593	120	37/2.06	10.2	15.0	19.0	28.2	4.6	32	11	15	15	73	KC-ALS-257
594	120	37/2.06	12.7	15.0	19.0	28.2	4.6	32	11	15	15	73	KC-ALS-230
595	120	37/2.06	16.2	15.0	19.0	28.2	4.6	32	11	15	15	73	KC-ALS-231
596	150	37/2.24	10.2	16.5	21.5	30.9	5.0	34	11	17	17	79	KC-ALS-258
597	150	37/2.24	12.7	16.5	21.5	30.9	5.0	34	11	17	17	79	KC-ALS-232
598	150	37/2.24	16.2	16.5	21.5	30.9	5.0	34	11	17	17	79	KC-ALS-233
599	185	37/2.5	10.2	18.6	24.0	34.6	5.5	36	12	18	18	84	KC-ALS-311
600	185	37/2.5	12.7	18.6	24.0	34.6	5.5	36	12	18	18	84	KC-ALS-234
601	185	37/2.5	16.2	18.6	24.0	34.6	5.5	36	12	18	18	84	KC-ALS-235
602	225	37/2.8	12.7	21	27	39.0	6.0	40	14	20	20	94	KC-ALS-320
603	240	37/3.0	12.7	22	28	40.0	6.0	44	14	22	22	102	KC-ALS-236
604	240	37/3.0	16.2	22	28	40.0	6.0	44	14	22	22	102	KC-ALS-237
605	300	61/2.5	16.2	24	31	45.7	7.0	47	14	27	27	115	KC-ALS-300
606	300	61/2.5	20.3	24	31	45.7	7.0	47	14	27	27	115	KC-ALS-259
607	400	61/3.0	20.3	28	36	51.0	8.0	56	13	31	30	130	KC-ALS-260
608	500	91/2.65	20.3	31	41	58.7	10.0	60	15	33	32	140	KC-ALS-296
609	625	91/3.0	20.3	36	46	66.6	10.0	69	16	35	34	154	KC-ALS-261
610	800	91/3.35	---	39	51	73.3	12.0	77	25	39	39	180	KC-ALS-318
611	1000	91/3.75	---	43.5	57	81.9	13.5	100	30	45	45	220	KC-ALS-319

ALLUMINIUM TUBULAR IN - LINE CONNECTORS FOR ALLUMINIUM CONDUCTORS

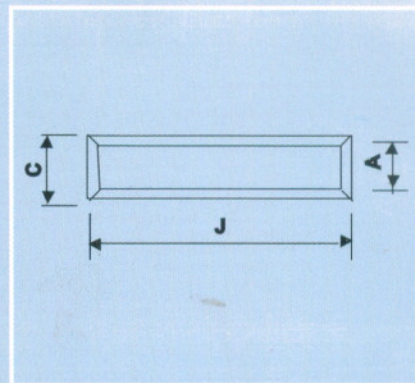

ALLUMINIUM IS : 5082

Item No.	AREA mm ²	CABLE SIZE	A	C	J	KAYCEE CAT. No.
612	2.5	1/1.8	2.0	5.5	16	KC-ALS-145
613	2.5	3/1.06	2.6	5.5	16	KC-ALS-6
614	4	7/0.85	2.9	5.5	16	KC-ALS-5
615	6	7/1.12	3.5	5.5	16	KC-ALS-13
616	10	1/3.55	3.8	6.2	20	KC-ALS-146
617	10	7/1.4	4.4	7.4	20	KC-ALS-14
618	16	7/1.7	5.4	8.3	26	KC-ALS-4
619	25	7/2.24	7.0	9.7	35	KC-ALS-3
620	35	7/2.5	8.0	10.8	40	KC-ALS-2
621	50	19/1.8	9.3	13.0	45	KC-ALS-12
622	70	19/2.24	11.6	16.0	55	KC-ALS-1
623	95	19/2.5	12.9	17.1	60	KC-ALS-15
624	120	37/2.06	15.0	19.0	65	KC-ALS-9
625	150	37/2.24	16.5	21.2	70	KC-ALS-10
626	185	37/2.5	18.5	24.0	75	KC-ALS-11
627	225	37/2.8	21.0	27.0	85	KC-ALS-147
628	240	37/3.0	22.0	28.6	90	KC-ALS-16
629	300	61/2.5	24.0	31.0	100	KC-ALS-17
630	400	61/3.0	28.0	36.0	115	KC-ALS-18
631	500	91/2.65	31.0	41.0	125	KC-ALS-19
632	625	91/3.0	36.0	46.0	140	KC-ALS-20
633	800	91/3.35	39.0	51.0	160	KC-ALS-148
634	1000	91/3.75	43.5	57.0	210	KC-ALS-149