

# DMC & SMC Insulators

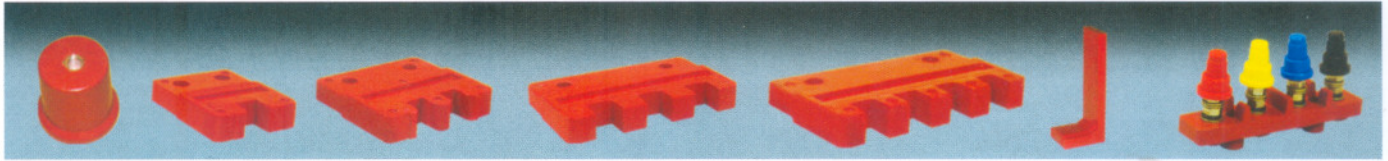

A good insulation system averts many a failure and protects the equipment. At KAYCEE, we know this and offer our customers superlative insulation products designed to sustain the generated temperature thereby sustaining the bus bar securely in any condition. We manufacture insulators of all types and sizes that are reliable, fire-proof and sturdy.

KAYCEE boasts of sophisticated technology at all its plants. The new-age, imported equipment at our manufacturing units ensures customers the very best quality; in fact, we use DMC material of high content of glass fibre. Every single insulator undergoes stringent quality norms through our testing facilities for unmatched mechanical strength and electrical performance.

Moreover, our pan India network with panel of experienced, prompt experts, provide viable solutions to our customers. We have a number of dealers and distributors across India.

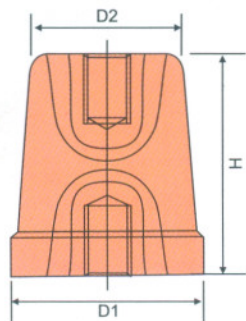

## BUS BAR SUPPORTS - CONICAL TYPE

ITEM CODE	TYPE	D1	D2	H
KCC630	30 X M6	30	26	30
KCC830	30 X M8	30	26	30
KCC840	40 X M8	40	31	40
KCC1040	40 X M10	40	31	40
KCC1050	50 X M10	50	40	50
KCC1260	60 X M12	50	40	60

Material : DMC / SMC Brass Inserts

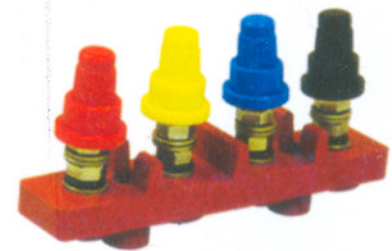
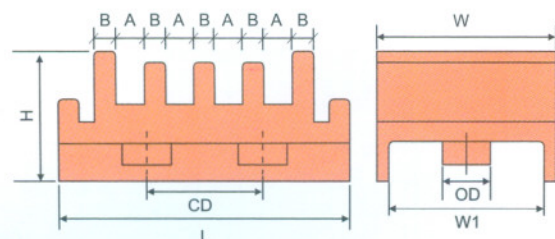
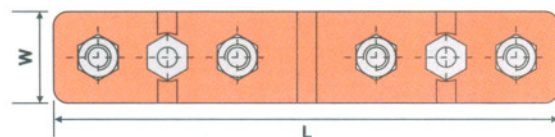
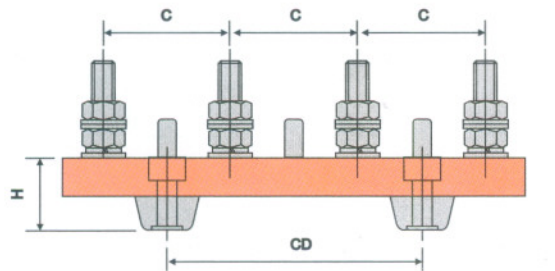

## STUD TERMINALS

TYPE	L	H	CD	C	W
KCST4(60A)	120	20	60	30	26
KCST4(100A)	165	26	90	45.5	30

## BUS BAR SUPPORTS - GRIP TYPE

ITEM CODE	WAY	A	B	L	H	CD	W	W1	OD
KCBSGT2	2	7.8	5.6	51	26	30	47	38.5	13
KCBSGT4	4	7.4	5.5	76	30	30	47	38.5	1

Material : DMC/SMC



# BUS BAR SUPPORTS - FINGER TYPE

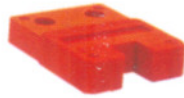
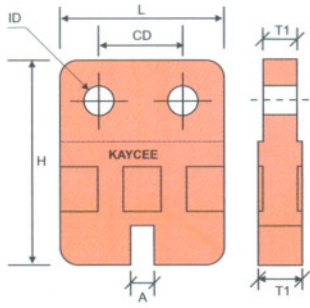

## ONE WAY FINGER TYPE

ITEM CODE	WAY	BUS BAR THK.	A	L	H	CD	ID	T	T1
KCFT106	1	6	7.4	51.5	65	26.5	9.5	10.5	13.5
KCFT110	1	10	11	51.5	65	26.5	9.5	10.5	13.5
KCFT112	1	12	13	51.5	65	26.5	9.5	10.5	13.5

Material DMC/SMC

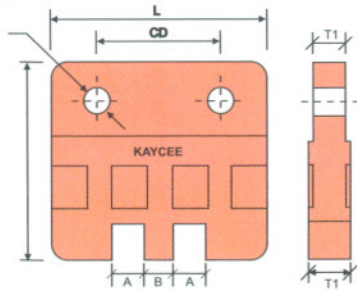

## TWO WAY FINGER TYPE

ITEM CODE	WAY	BUS BAR THK.	A	B	L	H	CD	ID	T	T1
KCFT206	2	6	7.4	7.8	70	66	40	8.5	10	14
KCFT210	2	10	12	9.6	70	66	40	8.5	10	14
KCFT212	2	12	13	12.5	70	66	40	8.5	10	14

Material DMC/SMC

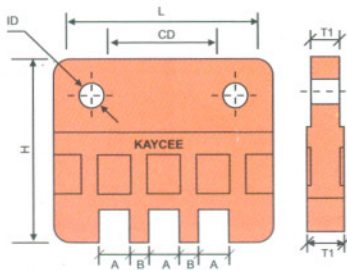

## THREE WAY FINGER TYPE

ITEM CODE	WAY	BUS BAR THK.	A	B	L	H	CD	ID	T	T1
KCFT306	3	6	7.4	7	80	67	50	9	11	14
KCFT310	3	10	11	10	80	67	50	9	11	14
KCFT312	3	12	13.5	12	100	67	50	9	11	14

Material DMC/SMC

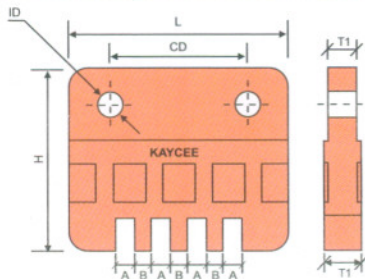

## FOUR WAY FINGER TYPE

ITEM CODE	WAY	BUS BAR THK.	A	B	L	H	CD	ID	T	T1
KCFT406	4	6	7.4	6	80	67	50	8.6	10	14
KCFT410	4	10	11.5	14.6	118	70	75	10	12	16
KCFT412	4	12	13.5	12	118	70	75	10	12	16

Material DMC/SMC

# L Shape Insulator

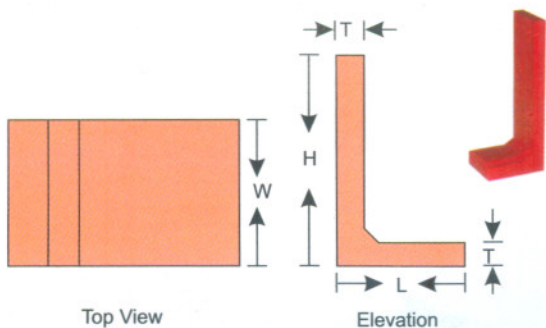

## L TYPE

ITEM CODE	Length	Width	Height	Thickness
KCL60D	40	50	60	10
KCL85D	40	50	85	10
KCL100D	40	50	105	10
KCL125D	40	50	125	10

Material DMC/SMC





- »» Resistance to high as well as sub zero temperature
- »» Almost no moisture absorption.
- »» Arc resistance ( Among Highest in plastic )
- »» High strengthStiffness comparable to metals
- »» Non flammable fire resistance.

- »» Weathering properties for outdoor.
- »» Excellent surface finish.
- »» Free from warp & sink mark.
- »» Chemicals, Acids, Alkalis, Solvents, Oil & Grease resistance

## Technical Specification for DMC / SMC

Properties	Units	Tolerance	Test Methods (ASTM)	Values	
				SMC	DMC
<b>PHYSICAL</b>					
Specific Gravity		+0.05	D-792	1.7	1.9
Glass Contents	%	<	N.A	25	15
Water Absorption (24 hrs)	%	<	D-570	0.2	0.15
<b>MECHANICAL</b>					
Tensile Strength	Kgf/Cm2	min	D-638	700	400
Flexural Strength	Kgf/Cm2	min	D-790	1550	900
Compressive Strength	Kgf/Cm2	min	D-695	1800	1500
Impact Strength	J/m	min	D-265	600	250
<b>ELECTRICAL</b>					
Dielectric Strength	KV/mm	min	D-149	12	10
Tracking Index	Volts	min	BS-5901	+600	+600
ARC Resistance	Secs.	min	D-495	+180	+180
Insulation Resistance	LLog10 ohms	min	BS2782	12.1	12.1
<b>THERMAL</b>					
Temp. of Defamation Under load	0C	min	BS-2872	200	200
Flammability			UL-94	Self Extinguishing	V-0