

TERMINAL TYPE (POLYAMIDE 6.6)
KUTM 2.5KUT 2.5
KUT 4, KST 4 U WS, KUT 6, KUT 10
KUT4 1x2
KUT4 2x2, KUDDT4 2x2
KST 6WS
KUT 16
KUT 25
KU2D 4, KU2D 4S
KUDD 4, KUDD 4CC1, KUDD 4CC2, KUDD 4CA1, KUDD 4CA2, KUDD 4D1, KUDD 4R, KUDD 4MOV
DU3D 4
DU5D 4
KULT 4, KULT 6, KULT 1
KUT 2.5N, KUT 4N, KUT 6N, KUT 10N, KUT 4NTCK, KUT 4NTCJ, KUT 4NTCI, KUT 4NTCE
KUDD4N, ETDD4N
KAT M3, KAT M4, KAT M5, KBT M4, KBT M5-15, KBT M6, KABT M4, KAT M3E, KAT M4E, KBT M4E, KBT M5E
OAT 2.5
OAT 6
OAT 6T
OAT 6DTS, OAT 6DTS-2W
KUF 10, KUF 10D, KUF 10A
KUFH 4, KUFH 4D, KUFH 4A
KLTD M4
KUTSD 6
KUTD 10
KULTD 6
KULTD 4, KULTD 4WS, KPCH 4, KUDDT 6
KUPFD 6, KUPFD 6S
KBT 100
DSCDT 6
PAT 30
KUPDS 6
DS3L 2.5

END PLATES
KPNS
KP X
KPM 4
KPMD 4
KSP6WS
KPY
KPT
EPDD 4
KPDD
DP3D
DP5D
KPSL
KPXN
KPDDN
KPS 4
OEP 2.5
OEP 6
OEP 6T
OEP 6DTS
EPF
EPFH
KPLD 4
KPSD
KPTD
KPSLD
KPSD 4
KPPDS
KPS 100
DSEPD 6
EPA 30
KPDS
DPDT 2.5

TERMINAL TYPE (POLYAMIDE 6.6)
UBT 4, UBT 6, UBT 10
UBT 2.5
UBT 4 TWIN
UBDD 4
SUT 1.5
SUT 4
NET 4
CET4
MBT 4
PET 4
DST 2.5, DSDPT 2.5
DST 4, DSET 4
DST 6, DSET 6
DSBL P16, DSBL P32
DST 10, DSET 10
DST 16
SCT 2.5
SCT 4
SCT 6 / SCT 10
DCT 2.5 - 1x2, DCT2.5 - 2x2, DET 2.5 - 1x2, DET 2.5 - 2x2
DST2.5 - 1x2
DST2.5 - 2x2
DSDD2.5
DSDT2.5
DSDT2.5 - 2x2
DCF 4, DCF 4D, DCF 4A
DCDT 4
MCT 1.5
MCT 2.5, MCT 2.5P4
MCT 2.5MC
MCT 4, MCT 4P4
PAT 100, PAT 150, PAT 250
PBT M4
DMCT 2.5P4

END PLATES
UP X
UPNS
UP TWIN
UPDD
ES 2
ES 4
EPMN
EPM
MP 1
EPP
DSEP 2.5
DSEP 4
DSEP 6
DSEP 8
DSEP 10
DSEP 16
SEP 2.5
SEP 4
SEP 6 / SEP 10
DMP 2.5
DSMP 2.5-1x2
DSMP 2.5-2x2
DPDD 2.5
DPD 2.5
DPMDT 2.5
DFEP
DCEP
MEP 1.5
MEP 2.5
MEP 2.5MC
MEP 4
EPA 100
EPB M4
DMEP 2.5P4

TERMINAL TYPE (MELAMINE)
CSTM 2.5, CUTM 2.5
CST 2.5, CST 6, CST 10, CST 2.5WS, CST 6WS, CUT 4, CUT 6, CUT 10
CST 16
CST 25
CST 35
CST 70
CST 185

END PLATES
KPNS
EP X
EP Y
EP T
EP Z
EP 70
EP 185

TERMINAL TYPE
CAT M3, CAT M4, CAT M5, CBT M4, CBT M5, CBT M6, CABT M4
CBT M6S1, CBT 100
CATD M4
CLTD M4
CSTD 6
CSLT 1
CUDD 4, CUDD 4S

END PLATES
EPS 4
EPS 5/6
EPD 4
EPLD 4
EPTD
EPSL
EPDD

TERMINAL TYPE (POLYAMIDE 6.6)
KUTM 2.5, KUT 2.5, DBK 2.5, DBM 4-10W
KUT 4, KST 4U WS, KUT 6, KUT 10, DBK 8, DBK 1x2, DBK 1x4, DBK 1x8, FDBK 8, FDBK 1x4, FDBK 1x8, FDBK 12
KST 6WS, KUT 16, DBK 150/16 1x2, DBK 150/16 1x4
KUT 25, DBK 150/25 1x2, DBK 150/25 1x4
UBT 2.5, UBT 4, UBT 6, UBT 10

BARRIER PLATES
KB M
KB X
KB Y
KB T
UB P

TERMINAL TYPE (POLYAMIDE 6.6)
KUTM 2.5, KUT 2.5, KUT 4, KST 4UWS, KUT 6, KUT 10, ET 4, ET 6, ET 10, KAT M3, KAT M4, KAT M5, KBT M4, KBT M5-15, KBT M6, KAT M3C, KAT M4C, KAT M5C, KBT M4C, KBT M5C-15, KBT M6C, OAT 2.5, OAT 6, DBK 8, DBK 1x2, DBK 1x4, DBK 1x8, FDBK 3, FDBK 8, FDBK 1x4, FDBK 1x8, FDBK 12, DBK 2.5, UBT 2.5, UBT 4, UBT 6, UBT 10, DBD 16, DBD35, DBM 4-10W, KABT M4, KAT M3E, KAT M4E, KBT M4E, KBT M5E, OAT 6HV
KUT 16, KUT 25, KUT 35, ET 16, ET 35, KULT 4, KULT 6, KULT 1, KUDD 4, KUDD 4D, KUDD 4A, KUDD 4F, KUDD 4G, KUDD 4H, KUDD 4I, KUDD 4J, KUDD 4K, KUDD 4L, KUDD 4M, KUDD 4N, KUDD 4O, KUDD 4P, KUDD 4Q, KUDD 4R, KUDD 4S, KUDD 4T, KUDD 4U, KUDD 4V, KUDD 4W, KUDD 4X, KUDD 4Y, KUDD 4Z, KUDD 4AA, KUDD 4AB, KUDD 4AC, KUDD 4AD, KUDD 4AE, KUDD 4AF, KUDD 4AG, KUDD 4AH, KUDD 4AI, KUDD 4AJ, KUDD 4AK, KUDD 4AL, KUDD 4AM, KUDD 4AN, KUDD 4AO, KUDD 4AP, KUDD 4AQ, KUDD 4AR, KUDD 4AS, KUDD 4AT, KUDD 4AU, KUDD 4AV, KUDD 4AW, KUDD 4AX, KUDD 4AY, KUDD 4AZ, KUDD 4BA, KUDD 4BB, KUDD 4BC, KUDD 4BD, KUDD 4BE, KUDD 4BF, KUDD 4BG, KUDD 4BH, KUDD 4BI, KUDD 4BJ, KUDD 4BK, KUDD 4BL, KUDD 4BM, KUDD 4BN, KUDD 4BO, KUDD 4BP, KUDD 4BQ, KUDD 4BR, KUDD 4BS, KUDD 4BT, KUDD 4BU, KUDD 4BV, KUDD 4BW, KUDD 4BX, KUDD 4BY, KUDD 4BZ, KUDD 4CA, KUDD 4CB, KUDD 4CC, KUDD 4CD, KUDD 4CE, KUDD 4CF, KUDD 4CG, KUDD 4CH, KUDD 4CI, KUDD 4CJ, KUDD 4CK, KUDD 4CL, KUDD 4CM, KUDD 4CN, KUDD 4CO, KUDD 4CP, KUDD 4CQ, KUDD 4CR, KUDD 4CS, KUDD 4CT, KUDD 4CU, KUDD 4CV, KUDD 4CW, KUDD 4CX, KUDD 4CY, KUDD 4CZ, KUDD 4DA, KUDD 4DB, KUDD 4DC, KUDD 4DD, KUDD 4DE, KUDD 4DF, KUDD 4DG, KUDD 4DH, KUDD 4DI, KUDD 4DJ, KUDD 4DK, KUDD 4DL, KUDD 4DM, KUDD 4DN, KUDD 4DO, KUDD 4DP, KUDD 4DQ, KUDD 4DR, KUDD 4DS, KUDD 4DT, KUDD 4DU, KUDD 4DV, KUDD 4DW, KUDD 4DX, KUDD 4DY, KUDD 4DZ, KUDD 4EA, KUDD 4EB, KUDD 4EC, KUDD 4ED, KUDD 4EE, KUDD 4EF, KUDD 4EG, KUDD 4EH, KUDD 4EI, KUDD 4EJ, KUDD 4EK, KUDD 4EL, KUDD 4EM, KUDD 4EN, KUDD 4EO, KUDD 4EP, KUDD 4EQ, KUDD 4ER, KUDD 4ES, KUDD 4ET, KUDD 4EU, KUDD 4EV, KUDD 4EW, KUDD 4EX, KUDD 4EY, KUDD 4EZ, KUDD 4FA, KUDD 4FB, KUDD 4FC, KUDD 4FD, KUDD 4FE, KUDD 4FF, KUDD 4FG, KUDD 4FH, KUDD 4FI, KUDD 4FJ, KUDD 4FK, KUDD 4FL, KUDD 4FM, KUDD 4FN, KUDD 4FO, KUDD 4FP, KUDD 4FQ, KUDD 4FR, KUDD 4FS, KUDD 4FT, KUDD 4FU, KUDD 4FV, KUDD 4FW, KUDD 4FX, KUDD 4FY, KUDD 4FZ, KUDD 4GA, KUDD 4GB, KUDD 4GC, KUDD 4GD, KUDD 4GE, KUDD 4GF, KUDD 4GG, KUDD 4GH, KUDD 4GI, KUDD 4GJ, KUDD 4GK, KUDD 4GL, KUDD 4GM, KUDD 4GN, KUDD 4GO, KUDD 4GP, KUDD 4GQ, KUDD 4GR, KUDD 4GS, KUDD 4GT, KUDD 4GU, KUDD 4GV, KUDD 4GW, KUDD 4GX, KUDD 4GY, KUDD 4GZ, KUDD 4HA, KUDD 4HB, KUDD 4HC, KUDD 4HD, KUDD 4HE, KUDD 4HF, KUDD 4HG, KUDD 4HH, KUDD 4HI, KUDD 4HJ, KUDD 4HK, KUDD 4HL, KUDD 4HM, KUDD 4HN, KUDD 4HO, KUDD 4HP, KUDD 4HQ, KUDD 4HR, KUDD 4HS, KUDD 4HT, KUDD 4HU, KUDD 4HV, KUDD 4HW, KUDD 4HX, KUDD 4HY, KUDD 4HZ, KUDD 4IA, KUDD 4IB, KUDD 4IC, KUDD 4ID, KUDD 4IE, KUDD 4IF, KUDD 4IG, KUDD 4IH, KUDD 4II, KUDD 4IJ, KUDD 4IK, KUDD 4IL, KUDD 4IM, KUDD 4IN, KUDD 4IO, KUDD 4IP, KUDD 4IQ, KUDD 4IR, KUDD 4IS, KUDD 4IT, KUDD 4IU, KUDD 4IV, KUDD 4IW, KUDD 4IX, KUDD 4IY, KUDD 4IZ, KUDD 4JA, KUDD 4JB, KUDD 4JC, KUDD 4JD, KUDD 4JE, KUDD 4JF, KUDD 4JG, KUDD 4JH, KUDD 4JI, KUDD 4JJ, KUDD 4JK, KUDD 4JL, KUDD 4JM, KUDD 4JN, KUDD 4JO, KUDD 4JP, KUDD 4JQ, KUDD 4JR, KUDD 4JS, KUDD 4JT, KUDD 4JU, KUDD 4JV, KUDD 4JW, KUDD 4JX, KUDD 4JY, KUDD 4JZ, KUDD 4KA, KUDD 4KB, KUDD 4KC, KUDD 4KD, KUDD 4KE, KUDD 4KF, KUDD 4KG, KUDD 4KH, KUDD 4KI, KUDD 4KJ, KUDD 4KK, KUDD 4KL, KUDD 4KM, KUDD 4KN, KUDD 4KO, KUDD 4KP, KUDD 4KQ, KUDD 4KR, KUDD 4KS, KUDD 4KT, KUDD 4KU, KUDD 4KV, KUDD 4KW, KUDD 4KX, KUDD 4KY, KUDD 4KZ, KUDD 4LA, KUDD 4LB, KUDD 4LC, KUDD 4LD, KUDD 4LE, KUDD 4LF, KUDD 4LG, KUDD 4LH, KUDD 4LI, KUDD 4LJ, KUDD 4LK, KUDD 4LL, KUDD 4LM, KUDD 4LN, KUDD 4LO, KUDD 4LP, KUDD 4LQ, KUDD 4LR, KUDD 4LS, KUDD 4LT, KUDD 4LU, KUDD 4LV, KUDD 4LW, KUDD 4LX, KUDD 4LY, KUDD 4LZ, KUDD 4MA, KUDD 4MB, KUDD 4MC, KUDD 4MD, KUDD 4ME, KUDD 4MF, KUDD 4MG, KUDD 4MH, KUDD 4MI, KUDD 4MJ, KUDD 4MK, KUDD 4ML, KUDD 4MN, KUDD 4MO, KUDD 4MP, KUDD 4MQ, KUDD 4MR, KUDD 4MS, KUDD 4MT, KUDD 4MU, KUDD 4MV, KUDD 4MW, KUDD 4MX, KUDD 4MY, KUDD 4MZ, KUDD 4NA, KUDD 4NB, KUDD 4NC, KUDD 4ND, KUDD 4NE, KUDD 4NF, KUDD 4NG, KUDD 4NH, KUDD 4NI, KUDD 4NJ, KUDD 4NK, KUDD 4NL, KUDD 4NM, KUDD 4NN, KUDD 4NO, KUDD 4NP, KUDD 4NQ, KUDD 4NR, KUDD 4NS, KUDD 4NT, KUDD 4NU, KUDD 4NV, KUDD 4NW, KUDD 4NX, KUDD 4NY, KUDD 4NZ, KUDD 4OA, KUDD 4OB, KUDD 4OC, KUDD 4OD, KUDD 4OE, KUDD 4OF, KUDD 4OG, KUDD 4OH, KUDD 4OI, KUDD 4OJ, KUDD 4OK, KUDD 4OL, KUDD 4OM, KUDD 4ON, KUDD 4OO, KUDD 4OP, KUDD 4OQ, KUDD 4OR, KUDD 4OS, KUDD 4OT, KUDD 4OU, KUDD 4OV, KUDD 4OW, KUDD 4OX, KUDD 4OY, KUDD 4OZ, KUDD 4PA, KUDD 4PB, KUDD 4PC, KUDD 4PD, KUDD 4PE, KUDD 4PF, KUDD 4PG, KUDD 4PH, KUDD 4PI, KUDD 4PJ, KUDD 4PK, KUDD 4PL, KUDD 4PM, KUDD 4PN, KUDD 4PO, KUDD 4PP, KUDD 4PQ, KUDD 4PR, KUDD 4PS, KUDD 4PT, KUDD 4PU, KUDD 4PV, KUDD 4PW, KUDD 4PX, KUDD 4PY, KUDD 4PZ, KUDD 4QA, KUDD 4QB, KUDD 4QC, KUDD 4QD, KUDD 4QE, KUDD 4QF, KUDD 4QG, KUDD 4QH, KUDD 4QI, KUDD 4QJ, KUDD 4QK, KUDD 4QL, KUDD 4QM, KUDD 4QN, KUDD 4QO, KUDD 4QP, KUDD 4QQ, KUDD 4QR, KUDD 4QS, KUDD 4QT, KUDD 4QU, KUDD 4QV, KUDD 4QW, KUDD 4QX, KUDD 4QY, KUDD 4QZ, KUDD 4RA, KUDD 4RB, KUDD 4RC, KUDD 4RD, KUDD 4RE, KUDD 4RF, KUDD 4RG, KUDD 4RH, KUDD 4RI, KUDD 4RJ, KUDD 4RK, KUDD 4RL, KUDD 4RM, KUDD 4RN, KUDD 4RO, KUDD 4RP, KUDD 4RQ, KUDD 4RR, KUDD 4RS, KUDD 4RT, KUDD 4RU, KUDD 4RV, KUDD 4RW, KUDD 4RX, KUDD 4RY, KUDD 4RZ, KUDD 4SA, KUDD 4SB, KUDD 4SC, KUDD 4SD, KUDD 4SE, KUDD 4SF, KUDD 4SG, KUDD 4SH, KUDD 4SI, KUDD 4SJ, KUDD 4SK, KUDD 4SL, KUDD 4SM, KUDD 4SN, KUDD 4SO, KUDD 4SP, KUDD 4SQ, KUDD 4SR, KUDD 4SS, KUDD 4ST, KUDD 4SU, KUDD 4SV, KUDD 4SW, KUDD 4SX, KUDD 4SY, KUDD 4SZ, KUDD 4TA, KUDD 4TB, KUDD 4TC, KUDD 4TD, KUDD 4TE, KUDD 4TF, KUDD 4TG, KUDD 4TH, KUDD 4TI, KUDD 4TJ, KUDD 4TK, KUDD 4TL, KUDD 4TM, KUDD 4TN, KUDD 4TO, KUDD 4TP, KUDD 4TQ, KUDD 4TR, KUDD 4TS, KUDD 4TT, KUDD 4TU, KUDD 4TV, KUDD 4TW, KUDD 4TX, KUDD 4TY, KUDD 4TZ, KUDD 4UA, KUDD 4UB, KUDD 4UC, KUDD 4UD, KUDD 4UE, KUDD 4UF, KUDD 4UG, KUDD 4UH, KUDD 4UI, KUDD 4UJ, KUDD 4UK, KUDD 4UL, KUDD 4UM, KUDD 4UN, KUDD 4UO, KUDD 4UP, KUDD 4UQ, KUDD 4UR, KUDD 4US, KUDD 4UT, KUDD 4UU, KUDD 4UV, KUDD 4UW, KUDD 4UX, KUDD 4UY, KUDD 4UZ, KUDD 4VA, KUDD 4VB, KUDD 4VC, KUDD 4VD, KUDD 4VE, KUDD 4VF, KUDD 4VG, KUDD 4VH, KUDD 4VI, KUDD 4VJ, KUDD 4VK, KUDD 4VL, KUDD 4VM, KUDD 4VN, KUDD 4VO, KUDD 4VP, KUDD 4VQ, KUDD 4VR, KUDD 4VS, KUDD 4VT, KUDD 4VU, KUDD 4VV, KUDD 4VW, KUDD 4VX, KUDD 4VY, KUDD 4VZ, KUDD 4WA, KUDD 4WB, KUDD 4WC, KUDD 4WD, KUDD 4WE, KUDD 4WF, KUDD 4WG, KUDD 4WH, KUDD 4WI, KUDD 4WJ, KUDD 4WK, KUDD 4WL, KUDD 4WM, KUDD 4WN, KUDD 4WO, KUDD 4WP, KUDD 4WQ, KUDD 4WR, KUDD 4WS, KUDD 4WT, KUDD 4WU, KUDD 4WV, KUDD 4WW, KUDD 4WX, KUDD 4WY, KUDD 4WZ, KUDD 4XA, KUDD 4XB, KUDD 4XC, KUDD 4XD, KUDD 4XE, KUDD 4XF, KUDD 4XG, KUDD 4XH, KUDD 4XI, KUDD 4XJ, KUDD 4XK, KUDD 4XL, KUDD 4XM, KUDD 4XN, KUDD 4XO, KUDD 4XP, KUDD 4XQ, KUDD 4XR, KUDD 4XS, KUDD 4XT, KUDD 4XU, KUDD 4XV, KUDD 4XW, KUDD 4XX, KUDD 4XY, KUDD 4XZ, KUDD 4YA, KUDD 4YB, KUDD 4YC, KUDD 4YD, KUDD 4YE, KUDD 4YF, KUDD 4YG, KUDD 4YH, KUDD 4YI, KUDD 4YJ, KUDD 4YK, KUDD 4YL, KUDD 4YM, KUDD 4YN, KUDD 4YO, KUDD 4YP, KUDD 4YQ, KUDD 4YR, KUDD 4YS, KUDD 4YT, KUDD 4YU, KUDD 4YV, KUDD 4YW, KUDD 4YX, KUDD 4YY, KUDD 4YZ, KUDD 4ZA, KUDD 4ZB, KUDD 4ZC, KUDD 4ZD, KUDD 4ZE, KUDD 4ZF, KUDD 4ZG, KUDD 4ZH, KUDD 4ZI, KUDD 4ZJ, KUDD 4ZK, KUDD 4ZL, KUDD 4ZM, KUDD 4ZN, KUDD 4ZO, KUDD 4ZP, KUDD 4ZQ, KUDD 4ZR, KUDD 4ZS, KUDD 4ZT, KUDD 4ZU, KUDD 4ZV, KUDD 4ZW, KUDD 4ZX, KUDD 4ZY, KUDD 4ZZ
DPBB 50, DPBB 70
DPBB 120
DPBB 185N, DPBB 240

BARRIER PLATES (With Foot)
KBXF
KBZF
KNBF2.5/10
BPN 70
BPN 120
BPA 185/240

TERMINAL TYPE (MELAMINE)
CST 2.5, CST 6, CST 10, CST 2.5WS
CST 16
CST 35
CBT 110, CBT 110T
CBT 170, CBT 170T, CBT 250, CBT 250T, CBT 300, CBT 300T

BARRIER PLATES
BP X
BP Y
BP Z
BPA 110
BPA 17/25

TERMINAL TYPE (MELAMINE)
CUT 4, CUT 6, CUT 10
CSTM 2.5, CST 2.5, CST 2.5WS, CST 6, CST 10, CST 6WS,
CUTM 2.5, CUT 4, CUT 6, CUT 10,
CST 16, CST 25, CSLT 1

BARRIER PLATES (With Foot)
CB X
KBXF
KBZF







Suitable for Terminal Type	Cross Connection Link Assembly	Removable Shorting Link		Comb Type Shorting Link
		Link	Long Stud	
CSTM 2.5, CUTM 2.5	CCLM 2.5	-	-	SLC 4N
CST 2.5, CST 2.5WS, CUT 4	CCLA 2.5	RSL 2.5	LSR 2.5-6	SLC 2.5
CST 6, CUT 6, CST 6WS	CCLA 6	RSL 6	LSR 2.5-6	SLC 6
CST 10, CUT 10	CCLA 10	RSL 10	LSR 10-16	SLC 10N
CST 16	CCLA 16	RSL 16	LSR 10-16	-
CST 25	CCLA 25	RSL 25	LSR 25	-
CST 35	CCLA 35	RSL 35	LSR 35	-
CSTD 6	-	-	-	SLC 6
CSLT 1	CCLA 1L	RSL 1L	LSR 1L	-
CAT M3	-	-	-	ASL 1
CAT M4, CATD M4, CLTD M4, CABT M4	-	-	-	ADSL/ADSLR
CBT M4, CBT M5	-	-	-	KSL 5
CUDD 4	CCLA DD	-	-	SLC 4N
CUDD 4S	-	-	-	SLC 4N

## ACCESSORIES - END CLAMPS

**END CLAMPS** : Also referred to as End Stoppers. Various types of End Clamps are available to suit different channels. End Clamps can also be used as "Spacers" to increase creepage distance between two terminals. End Clamps are available in metallic and Polyamide 66

			<table border="1"> <thead> <tr> <th>Type</th> <th>Suitable for Channel</th> <th>Thickness</th> </tr> </thead> <tbody> <tr> <td>SCS</td> <td>CHS (TS 32)</td> <td>11 mm</td> </tr> <tr> <td>SCSN</td> <td>CHS (TS 32)</td> <td>8.4 mm</td> </tr> <tr> <td>SCKN</td> <td>CHK (TS 35)</td> <td>8 mm</td> </tr> <tr> <td>SCUN</td> <td>CHS (TS 32)/CHK (TS 35)</td> <td>9.5 mm</td> </tr> <tr> <td>SCUDD</td> <td>CHS (TS 32)/CHK (TS 35)</td> <td>10 mm</td> </tr> <tr> <td>SCUSL</td> <td>CHS (TS 32)/CHK (TS 35)</td> <td>8 mm</td> </tr> <tr> <td>DCKN</td> <td>CHK (TS 35)</td> <td>8 mm</td> </tr> <tr> <td>SCMN</td> <td>CHM (TS 15)</td> <td>7.5 mm</td> </tr> </tbody> </table>	Type	Suitable for Channel	Thickness	SCS	CHS (TS 32)	11 mm	SCSN	CHS (TS 32)	8.4 mm	SCKN	CHK (TS 35)	8 mm	SCUN	CHS (TS 32)/CHK (TS 35)	9.5 mm	SCUDD	CHS (TS 32)/CHK (TS 35)	10 mm	SCUSL	CHS (TS 32)/CHK (TS 35)	8 mm	DCKN	CHK (TS 35)	8 mm	SCMN	CHM (TS 15)	7.5 mm	
Type	Suitable for Channel	Thickness																													
SCS	CHS (TS 32)	11 mm																													
SCSN	CHS (TS 32)	8.4 mm																													
SCKN	CHK (TS 35)	8 mm																													
SCUN	CHS (TS 32)/CHK (TS 35)	9.5 mm																													
SCUDD	CHS (TS 32)/CHK (TS 35)	10 mm																													
SCUSL	CHS (TS 32)/CHK (TS 35)	8 mm																													
DCKN	CHK (TS 35)	8 mm																													
SCMN	CHM (TS 15)	7.5 mm																													

## ACCESSORIES - MOUNTING RAILS

**MOUNTING RAILS** : The design complies with international standards, DIN EN 50035 for CHS, DIN EN 50022 for CHK, CHKS and DIN EN 50045 for CHM. Additionally gauging is done in-house on every elmex channel to provide dimensional accuracy within restricted tolerances. All channels are Alkaline Zinc Plated with Yellow Passivation to increase resistance to corrosion. The channels of 300 mm, 500 mm and 1000 mm lengths (with or without slots) are available as Standard Channels. elmex also provides Cut Length Channels as per the customers' design specifications.



## elmex Marking Labels

They are used for identification of circuit connections. Marking of the Terminals help in easy identification and quick maintenance. Marking Labels are made of Polyamide in white colour and pre-printed with black indelible ink.

Printing upto 3 digits/combination of Alphanumeric is possible.

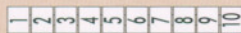
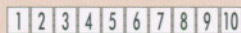

### Snap-on Type Marking Label Card

Snap-on Type Marking Label card consists of 100 Markers, 10 strips, each consisting of 10 Labels.

### Snap-on Type Marking Label Strip

This marking system consists of ten individual marking labels in a strip. The Strip can be snapped onto ten terminal blocks together or can be broken at any point for individual marking.

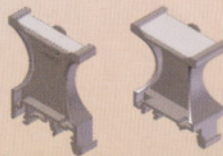

GMH 10 GMH 20

### Group Marking Holders

Group Marking Holders are used to separate and identify a stack of terminal blocks. They are Universal Rail mounted. A thick paper strip is inserted into the groove on the holder and transparent PVC strip protects the writing on the paper.

**GMH 10 - 10 mm Thick**  
**GMH 20 - 20 mm Thick**

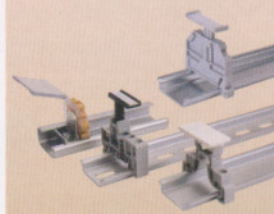

### Group Marking Carriers

Group Marking Carriers cater to the need of identifying different groups of terminal Blocks.

**SCUN MLH** - A Marking Label Holder is fixed on Universal Rail Mounted Side Clamp Type : SCUN. This facilitates the Group Marking of the Terminals mounted on either on channel type TS32 or TS35. A thick paper strip is inserted into the groove on holder and transparent PVC Strip protects the writing on the paper.

### SCKN MLH/DCKN MLH-

A White Marker with larger writing area is snapped onto the groove of TS35 Rail Mounted Side Clamp Type: SCKN/DCKN

**GMC** - It is made of transparent PVC, mounted at any end of the Terminal Block stack with the help of Side Clamp. It is suitable for TS 32 Rail.



### Warning Labels

Warning Labels (Attention or Danger Plate) are available in yellow colour with Red Printing for Mounting on the Group of Four standard Type Terminal Blocks.

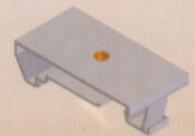

### Mounting Base

Mounting Base type **MBCHK** is used to make the components DIN Rail mounted. It contains a tapped hole to enable the fixing of components on to a DIN Rail.

### SNAP ON TYPE MARKING STRIP

Label KN 5	KUTM 2.5, SUT 1.5, DCT 2.5N, DST 2.5, SCT 2.5, DCT 2.5-1x2, DCT 2.5-2x2, DST 2.5-1x2, DST 2.5-2x2, DSDPT 2.5, DSDT 2.5, DSDT 2.5-2x2, DET 2.5-1x2, DET 2.5 - 2x2, SCT 2.5MC
Label KN 5.5	KUT 2.5, KULT 4, ET 4, KUT 4NTCK, KUT 4NTCJ, KUT 4NTCE, KU2D 4, KU2D 4S, KUDD 4, DU3D 4, DUSD 4, KLTD 4, KULTD 4, KULTD 4WS, DBK 2.5, DBM 4, DBP 4, SUT 4, DCT 4N, DST 4, SCT 4, DSET 4, MCT 2.5, DSDD2.5, KUT4-1x2, KUT4-2x2, SET 4, KPCH 4, ETDD 4N, KUDD 4 - 2x2, MCT 1.5, MCT 2.5MC, DBP 4-10W, DBM 4-10W, DS3L 2.5
Label KN 6.5	KUT 4, KST 4UWS, ET 6, KAT M3, KAT M4, KAT M4C, KAT M5, KAT M5C, KBT M4, KBT M4C, KBT M5-15, KBT M5-15C, KBT M6, KBT M6C, OAT 2.5, PS 8M, FDBK 3, FDBK 4, FDBK 5, FDBK 6, FDBK 8, FDBK 1x2, FDBK 1x4, FDBK 1x8, FDBK 12, DBK 150/M6C-1x2, DBK 150/M6C-1x4, DBK 150/M6C-1x8, CET 4, NET 4, MCT 4, KNL 4, DS8L P16, KABT M4, KAT M3E, KAT M4E, KBT M4E, KBT M5E
Label KN 8	KUT 6, KST 6WS, KULT 6, KUDF 4, KUDF 4A, KUDF 4D, KUDDF 4, KUDDF 4A, KUDDF 4D, KUTSD 6, KUTD 10, KULTD 6, DST 6, DCF 4, DCDT 4, DSET6, KNL 16, DSCD 6, DSCDT 6, KUPTD 6, KUPTD 6S, KUPDS 6, PAT 30, PAT 100, PAT 150, PAT 250, KUDD 6, SCT 6
Label KN 9	OAT 6, OAT 6HV, OAT 6T, KUFH 4, KUFH 4A, KUFH 4D, OAT 6DTS, OAT 6DTS-2W
Label KN 10	KUT 10, KULT 1, DPBB 50, DPBB 70, DPBB 120, DPBB 185N, DPBB 240, DFBK 12, DBK 3, DBK 4, DBK 5, DBK 6, DBK 8, DBK 1x2, DBK 1x4, DBK 1x8, DST 10, LPT 225, LPT 325, KNL 35, DSET 10, MCT 2.5P4, SCT 10, DMCT 2.5P4
Label KN 12	KUT 16, KUT 25, ET 16, ET 35, KUF 10, KUF 10A, KUF 10D, DBK 150/16-1x2, DBK 150/16-1x4, DBK 150/16-1x6, DBK 150/16-1x8, DBK 150/25-1x2, DBK 150/25-1x4, DBK 150/25-1x8, DST 16, LPT 235, LPT 335, DBD 16, DBD 35, MCT 4P4
Label KN 17	KUT 35, KUT 50, KUT 95, ET 50, KBT 100, SPT 35, SPT 70
Label U 6	MBT 4, UBT 2.5, UBT 4, UBDD 4, UBT 4TWIN, EBT 2.5, EBT 4, EBT 4TWIN
Label U 8	UBT 6, EBT 6
Label U 8.25	UBDF 4, UBDF 4A, UBDF 4D
Label U 10	UBT 10

### WARNING LABELS

WL 2.5	KUTM 2.5, KUT 2.5
WL 2.5N	KUT 2.5N
WL 4	KUT 4, KST 4UWS, KUT 4N
WL 6	KUT 6, KST 6WS
WL 10	KUT 10
WL 16	KUT 16, KUT 25
WL 35	KUT 35

### SUITABLE FOR TERMINAL TYPE

KUTM 2.5, KUT 2.5
KUT 2.5N
KUT 4, KST 4UWS, KUT 4N
KUT 6, KST 6WS
KUT 10
KUT 16, KUT 25
KUT 35



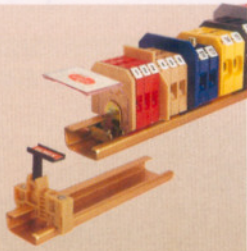

SNAP-ON LABEL	SUITABLE FOR TERMINAL TYPE	WARNING LABEL	SUITABLE FOR TERMINAL TYPE
Label KN5.5	CSTM2.5, CST35, CATDM4, CLTDM4, CUTM2.5, CUDD4, CUDD4S	WL 2.5	CST 2.5, CST 2.5WS, CUT 4
Label KN6.5	CST2.5, CST6, CST2.5WS, CST6WS, CATM3, CBTM4, CBTM5, CSTD6, CUT4, CUT6	WL 6	CST 6, CUT 6
Label KN8	CATM4, CATM5, CBTM6, CBTM6S1, CBT100, CABTM4	WL 10	CST 10, CUT 10
Label KN10	CST10, CST16, CSLT1, CBT110, CBT170, CBT250, CBT300, CBT110T, CBT170T, CBT250T, CBT300T, CUT10	WL 16	CST 16
Label KN12	CST25	WL 25	CST 25
Label KN17	CST70, CST185	WL 35	CST 35

## ACCESSORIES - SUPPORT FOR PROTECTION COVER

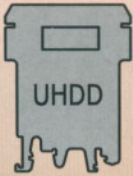

### TERMINAL TYPE

KUTM 2.5, KUT 2.5, KUT 4, KUT 4-1x2, KST 4UWS, KUT 6, KST 6WS, KUT 10, KUT 16, KUT 25, KUT 35, ET 4, ET 6, ET 10, ET 16, ET 35, KU2D 4, KU2D 4S, KULT 4, KULT 6, KULT 1, KUT 2.5N, KUT 4N, KUT 6N, KUT 10N, ETN 4, ETN 6, ETN 10, OAT 2.5, OAT 6, OAT 6T, KULTD 4, KULTD 4WS, KUDD 4CC1, KUDD4 CC2, KUDD4 D1, KUDD 4R, KUDD 4CA1, KUDD 4CA2, KUDD 4MOV, UBT 2.5, UBT 4, UBT 4TWIN, UBT 6, UBT 10, EBT 2.5, EBT 4, EBT 6, EBT 4TWIN, CSTM 2.5, CST 2.5, CST 6, CST 10, CST 16, CST 25, CST 35, CST 70, CST 2.5WS, CST 6WS, CSLT 1, CUTM 2.5, CUT 4, CUT 6, CUT 10, CUDD 4, CUDD 4S, KPCH 4, KPCH 4MC, KPCH 6, KUPDS 6, KUDT 6

### SUPPORT FOR PROTECTION COVER

UHDD

Protection Cover type PCK rests on UHDD and it shrouds the entire row of terminals which are mounted on a single Din Rail making the stack completely finger safe.

## PROTECTIVE COVERS



### PCST

Protective Transparent Covers are used for protection against dust. **elmex** offers protective transparent covers in PVC material which are directly fitted on the Terminal Blocks with Nylon Screws. This cover is also available in cut-length apart from standard length of 300 mm for standard feed through terminal types CST 2.5, CST 6, CST 10, CUT 4, CUT 6 and CUT 10.



### PCP

Protective Transparent Covers are used to cover the live parts where the contacts of the terminals do not form fully shrouded assemblies. **elmex** offers Protective Transparent Covers in PVC material for Power (Bus Bar) Melamine Terminals which are directly fitted on the Barrier Plates with the help of adaptor to be fitted in the Terminal Block. These covers are available for individual Terminal Block only.

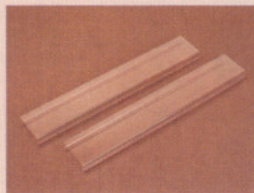

### PCC 3

Protective Transparent Covers are used to cover the live parts where the contact of the terminals do not form fully shrouded assemblies apart from providing protection against dust. **elmex** offers protective transparent covers in PVC material which are directly fitted on the terminal assemblies of all Stud Type Terminals. These covers are available in Cut-Length apart from standard length of 300 mm.



### PCD 3

Protective Transparent Covers are used to cover the live parts where the contact of the terminals do not form fully shrouded assemblies apart from providing protection against dust. **elmex** offers protective transparent covers in PVC material which are directly fitted on the terminal assemblies of CATD M4, CLTD M4 & KLTD M4. These covers are available in Cut-Length apart from standard length of 300 mm.



### PCCM & PCDM

**elmex** also offers the Protective Covers in moulded Polycarbonate material which can cover 2/3 Stud Type Terminals terminals. A notch is provided on the Covers for the ease of mounting and removal from terminals.

### COVER

PCST (300 mm)  
PCC 3 (300 mm)  
PCC 3K (300 mm)  
PCP 110  
PCP 120  
PCP 170  
PCP 250

### SUITABLE FOR TERMINAL

CST 2.5, CST 6, CST 10, CUT 4, CUT 6, CUT 10, KUT 4, KUT 6, KUT 10  
CAT M3, CAT M4, CBT M4, CBT M5, CBT M6, CABT M4  
KAT M3, KAT M4, KAT M5, KBT M4, KBT M5-15, KBT M6, KABT M4, KAT M3E, KAT M4E, KBT M4E, KBT M5E  
CBT 110, CBT 110T (Covers 1 Terminal Block)  
DPBB 50, DPBB 70, DPBB 120 (Covers 1 Terminal Block)  
CBT 170, CBT 170T (Covers 1 Terminal Block)  
CBT 250, CBT 250T, CBT 300, CBT 300T (Covers 1 Terminal Block)  
KUTM 2.5, KUT 2.5, KUT 4, KUT 4U WS, KUT 6, KST 6WS, KUT 10, KUT 16, KUT 25, KUT 35, ET 4, ET 6, ET 10, ET 16, ET 35, KU2D 4, KU2D 4S, KULT 4, KULT 6, KULT 1, KUT 2.5N, KUT 4N, KUT 6N, KUT 10N, OAT 2.5, OAT 6, OAT 6DTS, OAT 6DTS-2W, KUDD 4CC1, KUDD 4CC2, KUDD 4D1, KUDD 4R, KUDD 4CA1, KUDD 4CA2, KUDD 4MOV, UBT 2.5, UBT 4, UBT 6, UBT 10, EBT 2.5, EBT 4, EBT 6, EBT 4TWIN, CSTM 2.5, CST 2.5, CST 6, CST 10, CST 16, CST 25, CST 35, CST 2.5WS, CST 6WS, CSLT 1, ETN 4, ETN 6, ETN 10, KUT 4-1x2, KPCH 4, KULTD 4, KULTD 4WS, KUPDS 6, KUDT 4-2x2, OAT 6HV  
CATD M4, CLTD M4, KLTD M4  
CET (Covers 1 Terminal Block)

### COVER

PCCM 20  
PCCM 30  
PCCM 26  
PCCM 39  
PCCM 45K  
PCCM 60  
PCDM 26  
PCDM 39  
PCCM 17K  
PCCM 25.5K  
PCCM 34K  
PCCM 51K  
PCCM 52K  
PCCM 78K  
PCCM 40  
PCCM 24K  
PCCM 36K  
PCCM 30K  
PCCM 26K  
PCCM 39K  
PCCD 26  
PCCD 39

### SHROUDS 2/3 TERMINALS

CAT M3 (Covers 2 Terminal Blocks)  
CAT M3 (Covers 3 Terminals Blocks), CBT M4, CBT M5 (Covers 2 Terminals Blocks)  
CAT M4, CAT M5, CABT M4 (Covers 2 Terminal Blocks)  
CAT M4, CAT M5, CABT M4 (Covers 3 Terminal Blocks)  
CBT M4, CBT M5, KBT M5-15, KBT M5E (Covers 3 Terminal Blocks)  
CBT M6 (Covers 3 Terminal Blocks)  
CATD M4, CLTD M4 (Covers 2 Terminal Blocks)  
CATD M4, CLTD M4 (Covers 3 Terminal Blocks)  
KAT M3, KAT M3E (Covers 2 Terminal Blocks)  
KAT M3, KAT M3E (Covers 3 Terminal Blocks)  
KBT M6 (Covers 2 Terminal Blocks)  
KBT M6 (Covers 3 Terminal Blocks)  
KBT 100, CBT 100 (Covers 2 Terminal Blocks)  
KBT 100, CBT 100 (Covers 3 Terminal Blocks)  
CBT M6 (Covers 2 Terminal Blocks)  
KLTD M4 (Covers 2 Terminal Blocks)  
KLTD M4 (Covers 3 Terminal Blocks)  
KBT M5-15, KBT M5E (Covers 2 Terminal Blocks)  
KAT M4, KAT M5, KBT M4, KABT M4, KAT M4E, KBT M4E (Covers 2 Terminal Blocks)  
KAT M4, KAT M5, KBT M4, KABT M4, KAT M4E, KBT M4E (Covers 3 Terminal Blocks)  
CATD M4, CLTD M4 (Covers 2 Terminal Blocks)  
CATD M4, CLTD M4 (Covers 3 Terminal Blocks)